

- The few lockable cabinets are flimsy  
locks can be pulled open.
- Only one data jack, limits where
- Not enough space to store all the paper.
- Only (1) flat file → not enough for for  
paper/tissue.
- Basically storage they have not optimized  
for what they need to store.
- low work tops in chr of run → work great
- Not a good spot for cutting board, laminator
- Does turn lights down to one lamp when  
enough natural light available

- Good size, just needs to be utilized better.

- How use her sink → good to have in work room.  
- uses space under work to store stuff.

- Likes design of school over

- Security situation → where does anyone go in emergency

Emergency → have to go from one end to another → very far.

RR situation → couple in each wing but she has to use the one in the office

- One of office RR is being used for storage  
So not always enough → she has to go to other wing.

- Have to go to another room to get paper  
- Storage room adjacent to cafeteria.

Music Room 209 (12) 4/18

- Storage Room freezing. no occupancy sensor
- Storage space ready <sup>etc</sup> in storage
- Can see check for other users of room
- $\Sigma$  work  $\rightarrow$  likes
  - Not enough outlets
  - Not enough counter space
- Likes cabinets; tons of storage
- Use cubbies to store
- Made arm blinds for door sidelights
- No way to tell if door from locked from outside
- Door lock doesn't always work - sticks
- Temp. guard / summer froth sometimes in afternoon

- Move around a lot - so likes it cooler.
- likes lighting → has to turn lights completely off
- lights go off when she's by herself → warms
- Carpet → kids sit on floor → have started pulling up @ some edges.

---

Library/MEDIA - 2016 4/18 (13)

- love space - ~~and~~
- created great story space but can't see rest of library monitor.
- Love Light/space
  - Love Shelves on rollers/flexibility.
  - Shelving durable → did add some boxes

- On both side/hole are of problem
- Hard to regulate temp. in library but office
- EA always cold; Lib. sometimes
- Round duct in back wall → get dust through it into space
- HVAC sound loud, can make talking to students difficult.
- No noise from other spaces; does have rain on metal roof kind of loud.
- Configuration of duct not done good.
- Voice amplification system → works well
  - ↳ but has portable speaker she uses w/ kids because speaker not loud enough over HVAC.

• Carpet holding up pretty well; has cut off a few shags.

• No way away sensors

• Buck over usually keeps off because of windows.

• Tables became wobbly, but tightened up bolts if fine  
even

• Use to get saw smell on this side of school but seems to be fixed.

• This space is situated a long way down RR for kids & adults; probably would have been good for one in library.

• Duty in front in mag.

— Front doors lined up w/ doors to playground  
— creates strong breeze through when both open.

• Been a really fun experience having a new school  
— kids think!

- Recycling; both now make an effort to turn off lights
  - ↳ everyone aware
  - recycling used printer cartridges

Top thing staying on a visibility to change.

---

Counselor 101 4/18 (14)

Ltg guard

Conducting classroom

- Varies between individual students & in groups
- For individual students, turning off lights for some kids an issue;
- Temp. good most of time.  
Thermostat hard to understand though

- Tables/chairs work out.
- carpet holding up well.
- Cabinets work out well.
- See kids reading in dark in corridor  
→ need for activities → cinema
- RAs ok.
- Really like kind of school, big windows,  
very welcoming, very accessible  
have also done.
- Wouldn't change anything

Computer lab 102 (15) 4/18

Can be difficult to fit tables w/ computers where desks are; also have to have walking space

- thought out w/ computers/table 1st, then  
30 computers min. desks.



Cabinets get in the way of putting tables up

Storage cabinets great but taking up valuable  
- Need a good teacher station w/ all of these parts built in that would be

freq. fluctuates a lot, all day;

Mobile cart they have too big; doesn't fit in closets  
(or lockers) will need separate small closet in each wing of school for mobile technology.  
has to wheel from one end to another

- Projector carts w/ light fixture

- Lighting works ok

- Carpet holding up ok; a few strands now & then but janitor clips them.

- No sound issues

- Server smell gotten better → was @ library  
- Sean to have fixed it. Cafeteria  
- News items in library

- IT → great wireless capacity

- Utilize library for IT storage → (1) room  
- ~~no~~ no shelves  
- ~~had~~ had shelves

- Biggest Success

- Need a slightly bigger office but (are having  
(2) computers → w/ testing must have (2)

- Teachers love it too → great access

- ~~Get the~~ Cut testing in  $\frac{1}{2}$  so they're  
available 2 weeks sooner.

- Like having separate gym & cafeteria

- Like having enough space for conf. rooms  
& for testing - quiet space

- Kitchen 214 c Tupia 4/18 (16)

Could be bigger - could be a safety hazard

- Storage could be a bit bigger

- Serving de

- Need utility room to store chemicals

- little more room for bread racks

- Dish rack → tight → so small → scones / ice  
- Need a refrigerator a sauna

- Prepping 600 meals in box

- (1) more stove top would be nice.

- Sink on both sides of kitchen would be nice.

---

- PE (17) 4/18

Office is fine in what is needed

- Stringer Run → about double office
  - Not big enough to store anything
  - ↳ or 2 cubed
- Hake stage ⇒ binding wall
  - railings being down
  - kids run up against it & push
- kids have split head open on fanner when curbing goes
- Prefer Piffant flooring over hard tile
- Double classes up → gym not big
- Could improve conditions so in a lot
- No complaints about noise in other classrooms but maybe cafeteria
- Sound system works ok → some problems once in while w/ feedback.
- Hot spots by stage; cooling seems to work well.
- No odors besides body odor.
- Gel - all gasses die in field → no
  - not safe to run on

- Trade around outside pads panning/washes out
- Thermostats in gym get hit a lot. - once is missing a probable box → need cut cage; 2 to 3 workbooks

2026 is in a SITE SPECIALIST RESOURCE 4/16

Temp. → too cold - through wall panel (18)

Adjacent ant. run tied to next door room. → no thermostat → have to open/close door.

- None of the runs in this wing have occupancy sensors → why?
- Can hear workers through wall, just noticeable
- Sand & ants come through panel.
- Energy Storage → originally just had (1) cabinet got another one.
- Carpet ok
- Only (2) outlets, phones are blocked by desk  
has strip. enough
- Water doesn't get warm in attic RR

- Technology that was embedded when school opened biggest success.
- Conf. Room → wires running from table to wall
  - taped down.
- Temp. top of list to fix.
- Safety an issue → going out back for fire caught between burning bldg & fence
- LEED / Sustainability in mind, of teachers
  - not sure how aware kids are of it but teachers try to model environmental values.

---

## 202c Social Worker

- Little shrill → max kids in here @ time 4 <sup>(19)</sup> 4/18
- have a need for up to 6 kids
- But, Steve w/OT & PT → have to go elsewhere

Temp fluctuates → Hot when hot outside & cold when cold  
 → doesn't have her own thermostat and

- Notices dust @ panel.
- would like daylight → full spectrum lighting  
→ replaced hers with this
- usually keeps lights off - likes big window.
- had to reorganize desk initially but works ok
- pull out tray under desk for keyboard table.  
move up to desk top → still not ray
- Lunge is PA/OT Run down hall → fall? (2) times  
- when HVAC kicked on she had an allergic reaction  
- first year this happened  
- other people also complaining @ that time
- Can hear adjacent spaces through wall but not  
bad.
- Carpet ok
- Seems to be a general awareness among tables/  
about green school stuff
- RR → get had in dust office w/ smell. is one by  
Cabela.

NURSE 205 (20) 4/18

- No daylight in nurse's suite w/out it.
- Nurse works front office → but here could get the 'in' nurse.
- Need emergency light in Nurse's office → get concussion at time.
- Enough beds; layout works.
- Has enough lockable cabinets → she has everything.
- Average # of scrapes from playground.
- Finishes holding up ok.
- No noise issues that bug her.
- Can just turn off lights over each bed.
- No issue w/ being able to see into nurse's office  
close door. head
- Close to office - works
- Has all equipment/furniture that she needs
- Sewer smell when it's warm → maybe from office  
V.R.R.



- Room 130 2nd grade 4/18 (21)

- Love storage in classroom; love moving whiteboard
- Love that lights turn
- Can't see chalk from desk
- Love cubbies & where the y'all placed. great flow.
- Temp. easy to control if they need to
- (2) computers could be better have 10.
- love technology;
- Usually have only 1 temp on.
- 20 students → works relatively well.
- Would prefer different desks/chairs that aren't as easy to use
- No noise issues
- No RR-ads sometime
- Love sink in classroom.

- Love these shoe shops if that you have to go through off. we to get into school,
- 1212 is 345 on opposite wing  $\rightarrow$  to
- Change  $\rightarrow$  Fencing to close things off
  - Better field  $\rightarrow$  grass grow, hard.
  - can't do field day.
- Only CA way into school (road)
- Ride up / Drop-off  $\rightarrow$  Buses get stuck in traffic 15/20 minutes to clear out
- Has enough outlets
- Shedding problems  $\rightarrow$  one fell on a kid last year.
- $\rightarrow$  Also flat down repairs
- $\rightarrow$  bought an ultrasonic device to keep ants out  $\rightarrow$  and problem in yard worked.
- Use sensor fans light, off on her by her self.

Apr Run 208 max 4/18 (22)

Too small → (3) 4th graders  
→ can't fit another table

- 24 is probably the max.

- Enough Storage

- Like natural lighting

- Like having 2 sinks

- Fun set up tables work; everything should be  
to follow accordingly

→ ~~5 work under~~ work under → takes persistence  
to get them address ed.

\* Can't do murals because they're isn't a place to  
move tables to.

\* Bigg st success: Technology pretty

\* Bigger run.

## PRINCIPAL (23) 4/19

- Temp. very difficult to regulate
  - Thermostat regulate next two offices
- Adequate size
- Could use a small closet to put things way out of public view.
- Sund → can still have glaucoma receptionist in adjacent office w/ doors closed — privacy
  - Don't really need door to adjacent office.
  - Good natural light.
- Nurses' office → no daylight
- Not sure there is adequate storage in school
  - paints, paper, carpet tiles, records from previous years, etc.
- Pkg space → not enough for growing
  - When it does bring debris from hill down into pkg lot.

- Looking @ getting speed bumps along
- Had Fire Marshall & Police Dept. out to make
- Need more cooperation from City → Park don't want to cause congestion.
- Duty position
- Outside lighting → enough lighting on walkways & play lot.
- Been in space 7 months
- Get small cones signs, signs
  - Starts in corner near main entrance & then filters through offices down to concourse.
- Playground areas → very adequate
  - maintaining open grass area difficult
  - adequate play opportunities
  - Hasn't seen sealed areas used.
- Carpet holding up

- Bathroom tiles problematic in Children's RR → scales into grant
- Sinks worn away from cleaning process → grant
- Maybe another flooring system → continuous

- Automatic fixtures → Sinks spray against minimum wall.
- Someone from district has to come out each time.
- No one @ school can access BMS software

- Technology is awesome → love sound systems
- kids love it

- Flatscreen just put in Tuesday → will use for messaging.

- Great tech person.

- Biggest success → room for children now
- but growing @ some point won't be large enough.

- Double edge sword.

- Long layout makes vertical & cross collaboration more difficult. → One grade level depends on another

- Able to have meetings in library → good
- other (2) offices could have been combined & have a book room.

Technology big success

• Zoning around school → not sure why this location was chosen. → good side zone for multi-family.

- Parking/flow → Storage → Change

- FR on K num good.

- Shell numbers will

→ Well utilized / no wasted space

- Not outlets / data ports in right locations

- Huge desk furniture + doors + windows constrain ability to reconfigure.

---

Someone grabbed me in the hall  
+ said workstation needs outlets in clusters islands





Observation Notes

Reception 4/18 8:25-9:45 (1)

<p>A – Activities are goal directed set of actions – things which people want to accomplish</p>	<p>E – Environments are the entire arena where activities take place</p>	<p>I – Interactions between a person and someone else, then building blocks of activities</p>	<p>O – Objects are building blocks of the environment, key elements sometimes put to complex or unintended uses, changing their function, meaning and context</p>	<p>U – Users are the occupants, the people providing the behaviors, preferences, and needs</p>
<p>Receptionist listening to messages on speaker phone. If principal was in. Students/parents coming in dropping kids off</p>	<p>Vending machine in corridor produces a loud hum. Lounge &amp; Nurses office Back door through adjacent short corridor Principal office just off of receptionist</p>	<p>Parents engaging w/ receptionist &amp; students Staff conversing w/ each other as they're passing through -Bunch of students congested @ door into office Let it open for about 20s felt wild air.</p>	<p>Sitting on the orange couch have a direct view into Nurses office &amp; end of the beds. -kl/door open a potential privacy issue. - Receptionist wears headset. - Definitely seems to help her perform her tasks. - Counter top scans the right light Plus lower section in center of the counter for kids.</p>	<p>Parents engaging w/ receptionist &amp; w/ students Teachers &amp; staff walking through. -Traffic picking up by 8:37</p>

**Observation Notes** ② - Manifest was 8:00am - 8:15

<p><b>A – Activities are goal directed set of actions – things which people want to accomplish</b></p>	<p><b>E – Environments are the entire arena where activities take place</b></p>	<p><b>I – Interactions between a person and someone else, then building blocks of activities</b></p>	<p><b>O – Objects are building blocks of the environment, key elements sometimes put to complex or unintended uses, changing their function, meaning and context</b></p>	<p><b>U – Users are the occupants, the people providing the behaviors, preferences, and needs</b></p>
<p>· Pastries w/ Parents                      · Parents waiting in vestibule &amp; outside Open doors @ 8:00                      - Come in and head down toward gym.                      · Wait in line outside gym &amp; slowly move through line to get pastries</p>		<p>Before doors open teachers into acting w/ kids &amp; students</p>	<p>Right before letting people in, shut the double doors leading down to each classroom wing.                      · TV mounted in main entrance/ facing door as you enter lobby                      - Was off.                      · As one family walked in, girl commented to dad: "Dad, did you see they got a new tv?"                      - Opportunity for messaging in gymnasium; missed opportunity for this particular event.                      - lights are on in lobby - probably aren't needed → at least the uplights</p>	

- 302 2.5
- Smell chemicals/gas if janitors spill anything in adjacent closet.
  - Ants
  - Occ. Sensor won't turn lights off e all

**Observation Notes** ③ Gym & Cafeteria Posters For Parents 8:20 - 8:36

<p><b>A – Activities are goal directed set of actions – things which people want to accomplish</b></p>	<p><b>E – Environments are the entire arena where activities take place</b></p>	<p><b>I – Interactions between a person and someone else, then building blocks of activities</b></p>	<p><b>O – Objects are building blocks of the environment, key elements sometimes put to complex or unintended uses, changing their function, meaning and context</b></p>	<p><b>U – Users are the occupants, the people providing the behaviors, preferences, and needs</b></p>
<p>Lasts from 8:00-8:45 - Then kids go outside Still using it @ 8:30</p>	<p>Lights on in both rooms; probably aren't needed in cafeteria.</p>	<p>Parents, students teachers/staff interact w/ each other.</p>	<p>OPEN wall 1/2 way up between cafeteria &amp; gym. Have chairs set up on exterior wall side of gym.</p>	

③

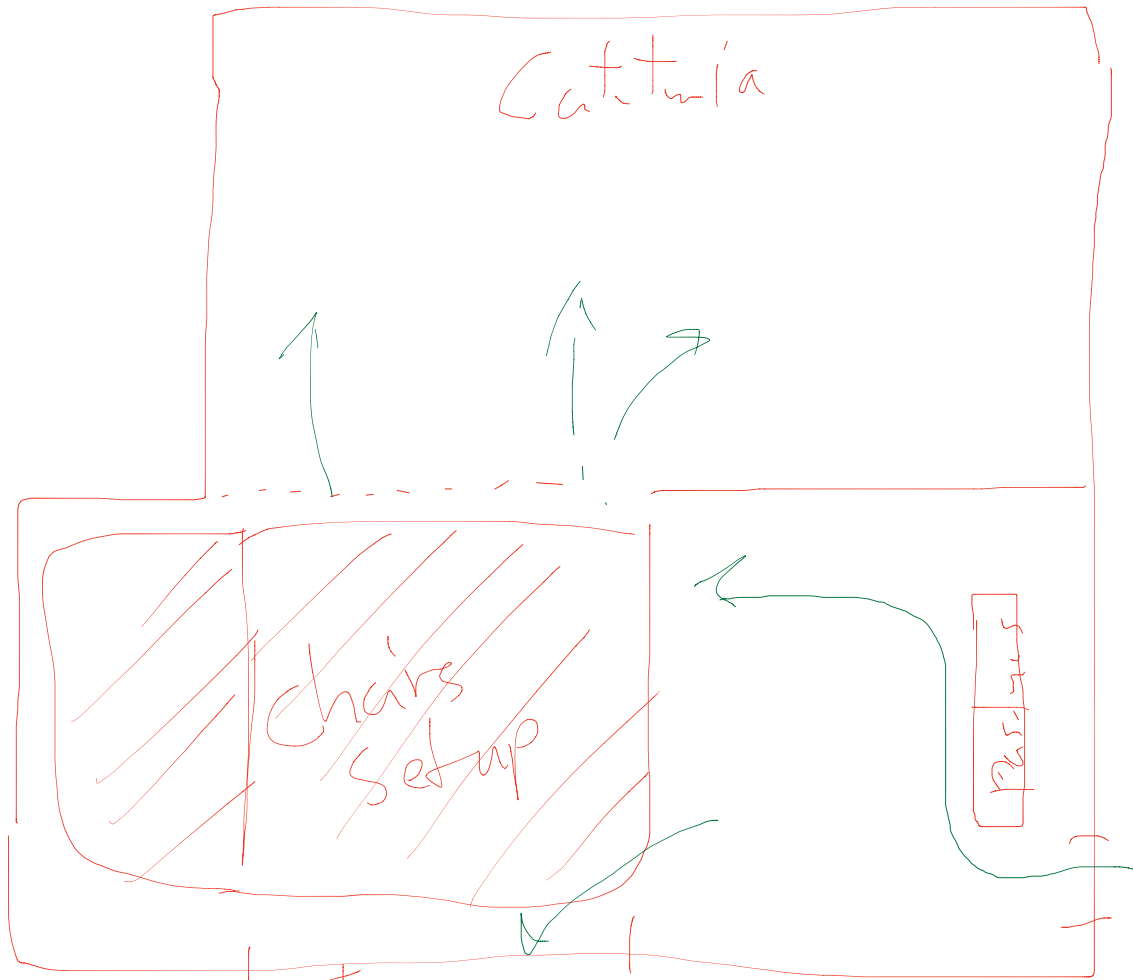

Stage  
sitting on  
stage too