



2428 Shawnee Dr. SE, Albuquerque, NM 87106  
Tel: 505-241-9955 Fax: 505-241-4109  
E-mail: mhga@mhgaarchitect.com  
www.mhgaarchitect.com

Consultant  
Address  
Phone

SECTION 05200 - MILLWORK  
1. MILLWORK SHALL BE AS-BUILT.  
2. MILLWORK SHALL BE INSTALLED IN ACCORDANCE WITH THE MANUFACTURER'S INSTALLATION INSTRUCTIONS.  
3. MILLWORK SHALL BE INSTALLED IN ACCORDANCE WITH THE MANUFACTURER'S FINISHING INSTRUCTIONS.  
4. MILLWORK SHALL BE INSTALLED IN ACCORDANCE WITH THE MANUFACTURER'S MAINTENANCE INSTRUCTIONS.  
5. MILLWORK SHALL BE INSTALLED IN ACCORDANCE WITH THE MANUFACTURER'S WARRANTY INSTRUCTIONS.  
6. MILLWORK SHALL BE INSTALLED IN ACCORDANCE WITH THE MANUFACTURER'S SAFETY INSTRUCTIONS.  
7. MILLWORK SHALL BE INSTALLED IN ACCORDANCE WITH THE MANUFACTURER'S ENVIRONMENTAL INSTRUCTIONS.  
8. MILLWORK SHALL BE INSTALLED IN ACCORDANCE WITH THE MANUFACTURER'S OTHER INSTRUCTIONS.

AS-BUILT

LAS CRUCES PUBLIC  
SCHOOLS  
NEW LAS CRUCES  
MIDDLE SCHOOL  
LAS CRUCES, NEW MEXICO  
585

BID PACKAGE #3  
CONSTRUCTION  
DOCUMENTS  
08/20/2009  
P08-008

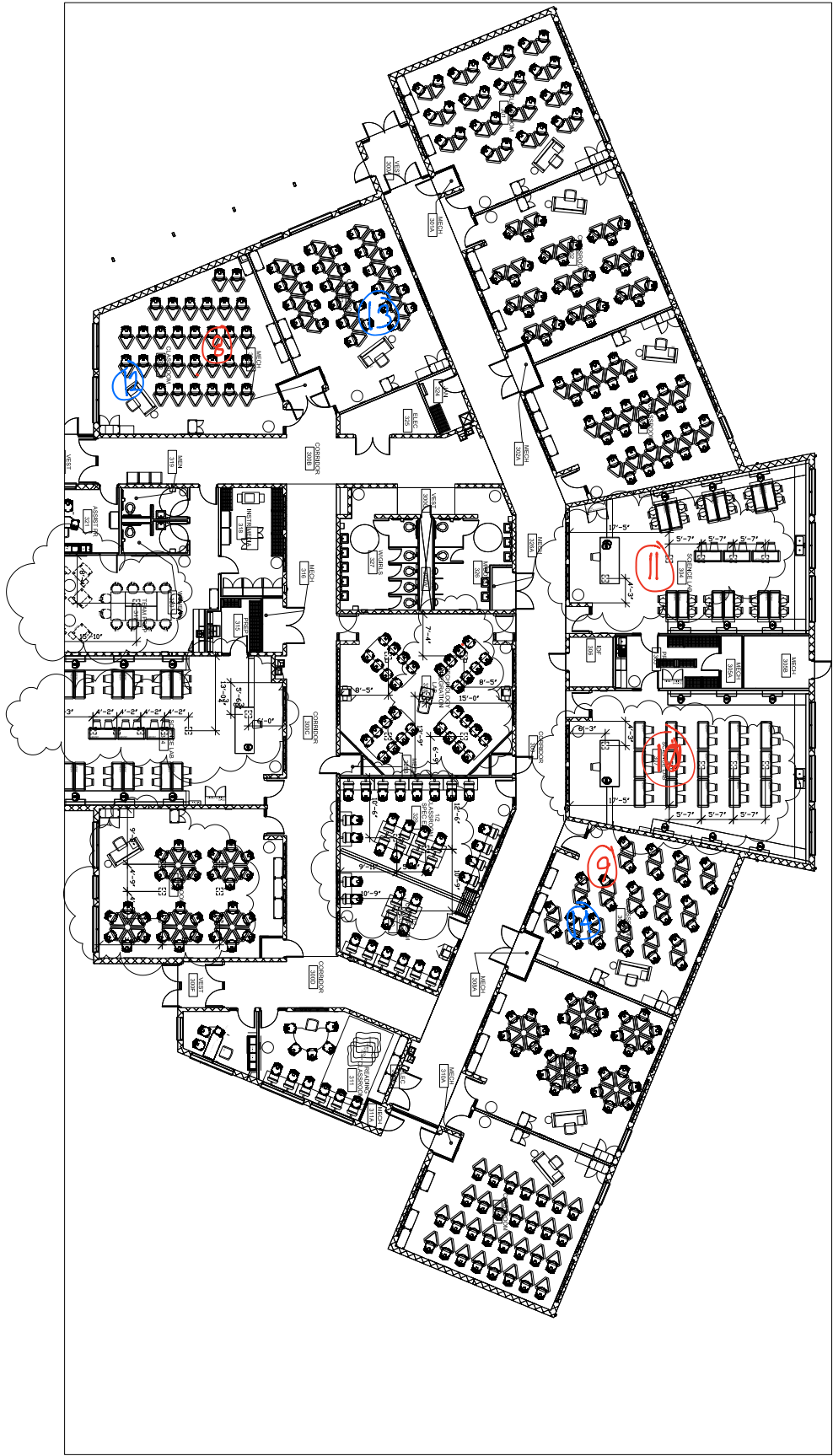
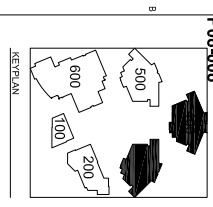

**A1** FURNITURE PLAN

Scale: 1/8" = 1'-0"

FURNITURE PLAN

## ⑧ Social Studies

### Love windows

Love that it's wider than most - get kids closer to sun

Use computers a lot - makes it easier for her to move around the room

Gets up to 75°/76° regularly → Uses manual override every day + bought fan it  
More comfortable in winter. keeps shades down in afternoon

Has enough outlets

Technology working out good - most of her class

- 30 laptops in cart for her room only

- Chairs wheels pretty firm

- Desks don't maintain height very well.

- easy to hit

- Not every desk has backpack hooks → gets in the way

- hard to

like desk wheels but not desks → take up too much space

hard to group

- lot of experimentation to reach correct configuration

- Typically keep lights off → kids like lights off; calming

- This age group doesn't really utilize books - not easily accessible → prefer back of chair.

- No lockers → book

- Podcast texts in audio if need be; prints information for those kids who don't  
have internet access.

- She does open one of the windows often → twice floor of air w/ door  
- other one catches dirt.

- No noise issues

- Drinking fountain/RR → needs re working

- because

- Cafeteria needs a big student RR

→ have to go into another building; many don't sit there have to go  
during class

## ⑨ Special Ed - 6 grade

Temp. → August too hot → thermostat d. isn't always out

Daylight → some glare on smart board  
but shades shades

- Likes the rollers on the furniture
- Likes separating 6, 7, 8. Hallways not too congested
- Likes all of the technology; sound system works well. - No problem w/ laptops → (2) carts plus (1) lap works

Team room is marvelous → fax, workroom

- Likes the furniture holding up well, Likes that kids can adjust them.
- Likes teacher plug in station
- Likes not having smart board mobile
- No TV
- Sensor has never turned off the lights off on her
  - dual technology.
- Likes the secure access → makes her
- Likes the tables available outside cafeteria for kids to sit at
- Likes cabinet storage → nicely organized.
- Furniture is color coded by grade.
- Netz puts limit where you can set up (?) locations

## (10) Science Lab (11) Science Lab

- Work stations sinks gen't & demonstration station
- No eyewash or shower
- @ least (1) shower station per bldg.
- 6th grade mostly food stuff
- Loves emergency shutdown → good location
- Covers for sinks unless in use needed → kids can stuff down.
- Appreciates lighting → multifixed
- Likes shades → can see out but not in
- Layout challenging w/ tables + 34 kids
- Likes counters against the wall.
- Originally didn't have white board & but it's board → asked for that.
- Need a surface to display work → (M 4  
~~work~~

doesn't work well.

Not enough stands @ teacher station

Holding → prefer real bulletin boards  
strips pull off wall → hazard in

- Important to get students work up
- Chemical storage in Prep Room.
- Storage in lab all where students are at.
- Originally had file cabinets, didn't see file cabinet
- Floor outlet was → difficult to access tripping hazard; never used them.
- Kids in back can't see smart board.
-

- Prop/Stone Room fabulous → makes it easier for science teachers to collaborate
- Gets noisy w/ collaboration but other classes don't complain.
  - External noise - lawn mowing ; jets
  - Easy access, but only one is handicap accessible

⑫ ~~Subs~~ ~~Exception~~ 422 - Social studies

Literacy Setup of bldg → grades are separated → good  
Loves technology, lighting

Takes a day or 2 to get temp. adjusted ~~have~~ change of season. but generally comfortable

Maybe more storage in this classroom for art type projects

Would like more display area per building

- No glare on smart board w/ shades raised.
  - Sometimes keeps lights off, especially w/ smart board
    - Group switch → Hirashima
  - Sometimes uses mic → dant in one ear, plus audio kids
  - Rattle snakes
- 

⑬

Smart board should be located on adjacent wall - glare from window + students can't see in back

- Blinds can't block out enough light - added paper.
- On sensor timer lights off on her.
  - only when (1) person is in here
- District set 75 but she does have an override & it works when she uses it.
- Consider light flickers in early dawn after daylight savings time.
- Had to have bulletin boards added.
- Love the amount outlets & charging options for phone/internet
- Like the furniture, though have had to work @ getting it to fit in small room.
  - holding up ok. well.
- Love height adjustment → no problem w/ them.
  - likes standing ok.
- likes mobility of everything



- Would like to see district take care of landscaping better
- No issues w/ security - feel they are safest campus in district.
- Uses iPads
  - Sometimes from many <sup>dead spots</sup> access e @notes
  - easier to access network on ipads instead of laptops
- Beautiful bldg & grounds
- Likes that its a green school; re
  - Science feeds <sup>networks</sup> into <sup>community</sup>

## ⑭ McKinstry Teacher

- Pretty good w/ hot locations; idk
- Process for moving phone to another jack
- Likes having diff. levels of lighting
  - cuben
- Temp. been pretty good →
- Shape of desks a problem - hard to organize/layout.

- Hold up pretty well. → Buttons to raise/lower or some are getting stuck.
- Rollers - some have broken.
- Never open window.
- Storage is ok, could use some more.
- Many → specialized - 17 locks → use iPads
  - make it easier to share
  - W/ desks
  - 10
  - + teacher iPad
- I don't think would have 1 to 1, but not bad.
  - keeps them on task, though
- Really like iMac labs + can check laptops carts out.
- Haven't use TV this year; but use smart board a lot
  - right now markers don't work
- Wireless mic not working right now. - haven't submitted a work order
-



2428 Shiloh Dr SE, Albuquerque, NM 87116  
Tel: 505-241-9955 Fax: 505-241-4109  
E-mail: mhga@mhgaarchitect.com  
www.mhgaarchitect.com

Consultant  
Address  
Phone

SECTION DETAILED

THIS DOCUMENT IS THE PROPERTY OF VAN H. GILBERT ARCHITECT P. IT IS TO BE USED ONLY FOR THE PROJECT AND SITE SPECIFICALLY IDENTIFIED HEREIN. IT IS NOT TO BE REPRODUCED, COPIED, OR TRANSMITTED IN ANY FORM OR BY ANY MEANS, ELECTRONIC OR MECHANICAL, WITHOUT THE WRITTEN PERMISSION OF VAN H. GILBERT ARCHITECT P. ANY UNAUTHORIZED USE OF THIS DOCUMENT IS PROHIBITED.

AS-BUILTS

LAS CRUCES PUBLIC  
SCHOOLS  
NEW LAS CRUCES  
MIDDLE SCHOOL

LAS CRUCES, NEW  
MEXICO

BID PACKAGE #3  
CONSTRUCTION  
DOCUMENTS  
08/20/2009  
P08-008

KEY PLAN

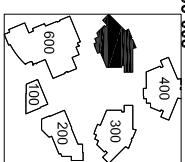

A1 FURNITURE PLAN  
Scale: 1/8" = 1'-0"

FURNITURE PLAN

15-101  
SHEET

(15) LA

- Front lights don't work submitted work order
- Would prefer dimmer for lighting → too bright
- Morning sun too bright w/ blinds shut, plus warm
- Technology plugged in it buzzes
- No bubble boards - need more
- Run pretty long → kids fed
- 30 kids pretty crowded
- TV → shows close view from back of room.
- Furniture is good. - does make use of adjustable height feature
- Thermostat delayed reaction:
  - Anyday they used some
  - Consider light flickers → early morning
  - 529 → sensor in corridor would go off.

(16) Temp. generally good → a few complaints  
that it was too hot if she couldn't get it to  
come on.

- Alarm goes off outside in corridor → low  
water pressure alarm - not very often.
  - Close door gets

- Got ants one day but custodians took care of it same day.
- Technology
- Sensor sometimes will turn lights off on bar.
- Emergency lights come on during last period
  - furniture great → comfortable, like adjusting height → not really a distraction - starting to notice graffiti
    - a few wheels break but fixed very quickly.
- Sounds all work → No glue issue, that is great
- Never open windows, but they've been told not to because of HVAC.
- Notice sound of kids in RR is somewhat consider but don't → can hear to monitor

- Minnow list is generally doesn't hang up a lot of stuff. → though would be nice to
  - can't get into the office from the courtyard  
Sometimes → no key card access
  - have library i tech labs
  - had boring in her own printer → too much of a hassle to use it in workroom → time waster
  - would like (1) printer per (2) classrooms
  - Tom Run sometimes a little hot.
  - Love their principals i custodians
- 

(17) Cloud doesn't work  
Uber override doesn't work  
Not enough storage

- Lighting is good → sometimes doesn't even have <sup>out</sup> gen.
- Fans generic
- No eyewash station or shower
- Furniture works well. likes rolling chairs holding up well
- layout works → enough outlets
- all technology is working
- sometimes make uses of floor outlets but none.
- No issues w/ sound
- Does use wireless microphone & it works ok.
- Chemical storage sufficient for needs

13

- Temp. gets rather warm in here
- Eyewash station needed → warm all year around
- Wheels break → Students sleep when its warm
- Furniture good
- Need teacher desk w/ lockable storage
- Mounted white board not visible to some kids & back.
- Overhead projector good
- Haven't hooked TV up yet so hasn't used.
  - otherwise technology good.
- Don't have need
- Books all trashed - using more of the archive material  
~~on the~~ would like to go to E-books
- Try to have (2) to student iPad → 10 iPads + his iPad Minis ; + MacBook Air + Smart Pro II w/ Apple TV, but needs a hard phy. drive
- Would like more iPads → 15 total when his class bigger than 30.
- Some of Swabs w/ recalibration → funny.
- Run to storage doesn't latch.
- Wishes they could get into other areas of school but not every door has secure access card



- Little crowded in corridors



2428 Bluff Dr SE Albuquerque, NM 87106  
Tel: 505.241-9665 Fax: 505.241-1109  
E-mail: mhga@vanhgilbert.com  
www.vanhgilbert.com

Consultant  
Address  
Address  
Address  
Phone

SECTION DETAILS  
REVISIONS  
DATE  
BY  
DESCRIPTION

AS-BUILTS

MESA MIDDLE  
SCHOOL  
LAS CRUCES, NM

LAS CRUCES, NEW  
MEXICO

BID PACKAGE #3  
CONSTRUCTION  
DOCUMENTS  
08/20/2009  
P08-008

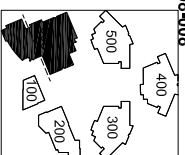

AS-BUILTS

NO.	DATE	DESCRIPTION
1	08/20/2009	ISSUED
2	08/20/2009	ISSUED
3	08/20/2009	ISSUED
4	08/20/2009	ISSUED
5	08/20/2009	ISSUED
6	08/20/2009	ISSUED
7	08/20/2009	ISSUED
8	08/20/2009	ISSUED
9	08/20/2009	ISSUED
10	08/20/2009	ISSUED
11	08/20/2009	ISSUED
12	08/20/2009	ISSUED
13	08/20/2009	ISSUED
14	08/20/2009	ISSUED
15	08/20/2009	ISSUED
16	08/20/2009	ISSUED
17	08/20/2009	ISSUED
18	08/20/2009	ISSUED
19	08/20/2009	ISSUED
20	08/20/2009	ISSUED
21	08/20/2009	ISSUED
22	08/20/2009	ISSUED
23	08/20/2009	ISSUED
24	08/20/2009	ISSUED
25	08/20/2009	ISSUED
26	08/20/2009	ISSUED
27	08/20/2009	ISSUED
28	08/20/2009	ISSUED
29	08/20/2009	ISSUED
30	08/20/2009	ISSUED
31	08/20/2009	ISSUED
32	08/20/2009	ISSUED
33	08/20/2009	ISSUED
34	08/20/2009	ISSUED
35	08/20/2009	ISSUED
36	08/20/2009	ISSUED
37	08/20/2009	ISSUED
38	08/20/2009	ISSUED
39	08/20/2009	ISSUED
40	08/20/2009	ISSUED
41	08/20/2009	ISSUED
42	08/20/2009	ISSUED
43	08/20/2009	ISSUED
44	08/20/2009	ISSUED
45	08/20/2009	ISSUED
46	08/20/2009	ISSUED
47	08/20/2009	ISSUED
48	08/20/2009	ISSUED
49	08/20/2009	ISSUED
50	08/20/2009	ISSUED
51	08/20/2009	ISSUED
52	08/20/2009	ISSUED
53	08/20/2009	ISSUED
54	08/20/2009	ISSUED
55	08/20/2009	ISSUED
56	08/20/2009	ISSUED
57	08/20/2009	ISSUED
58	08/20/2009	ISSUED
59	08/20/2009	ISSUED
60	08/20/2009	ISSUED
61	08/20/2009	ISSUED
62	08/20/2009	ISSUED
63	08/20/2009	ISSUED
64	08/20/2009	ISSUED
65	08/20/2009	ISSUED
66	08/20/2009	ISSUED
67	08/20/2009	ISSUED
68	08/20/2009	ISSUED
69	08/20/2009	ISSUED
70	08/20/2009	ISSUED
71	08/20/2009	ISSUED
72	08/20/2009	ISSUED
73	08/20/2009	ISSUED
74	08/20/2009	ISSUED
75	08/20/2009	ISSUED
76	08/20/2009	ISSUED
77	08/20/2009	ISSUED
78	08/20/2009	ISSUED
79	08/20/2009	ISSUED
80	08/20/2009	ISSUED
81	08/20/2009	ISSUED
82	08/20/2009	ISSUED
83	08/20/2009	ISSUED
84	08/20/2009	ISSUED
85	08/20/2009	ISSUED
86	08/20/2009	ISSUED
87	08/20/2009	ISSUED
88	08/20/2009	ISSUED
89	08/20/2009	ISSUED
90	08/20/2009	ISSUED
91	08/20/2009	ISSUED
92	08/20/2009	ISSUED
93	08/20/2009	ISSUED
94	08/20/2009	ISSUED
95	08/20/2009	ISSUED
96	08/20/2009	ISSUED
97	08/20/2009	ISSUED
98	08/20/2009	ISSUED
99	08/20/2009	ISSUED
100	08/20/2009	ISSUED

FURNITURE PLAN

FURNITURE PLAN  
Scale: 3/32" = 1'-0"

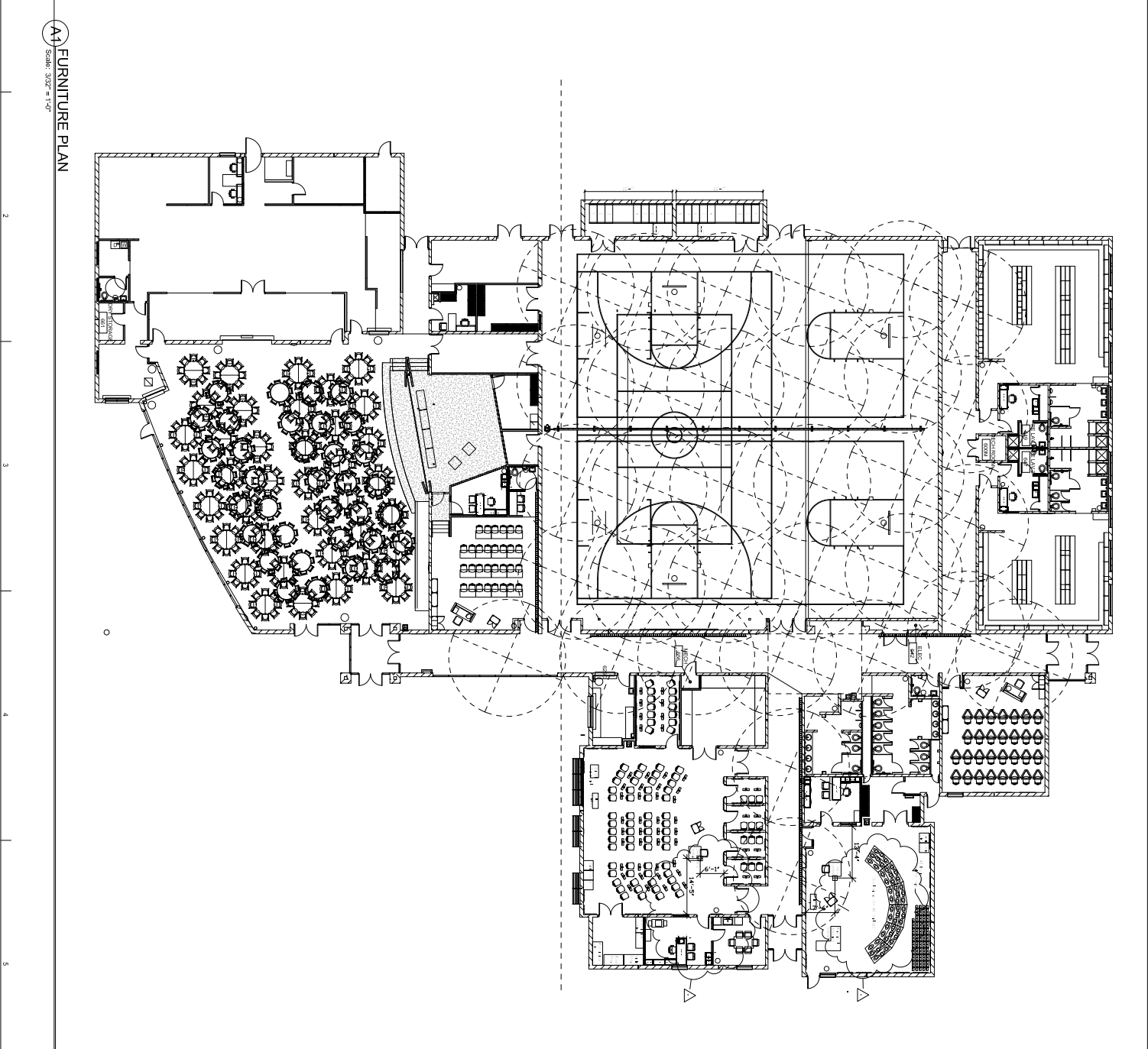

Bobby Turkovic 19

- loves ~~interior~~ black envelope  
beautiful, turned out ~~great~~.

- Aluminium store front doors - flex too much  
- physically pop open. <sup>aluminum frame</sup>

- back up truck to house & jump

- Issue w/ outside curtyard lty <sup>possibly</sup> & <sup>power</sup> supply

- Back parking lot lty → short in conductor

- PG&E pushed for ground source heat pumps system  
✓ → District prepared for

District believes ground temp. water has increased

→ think its a 20° increase  
Piping/circulation pumps → a few failures

• Control issues resolved after first 6/8 months  
Automated logic

• No plumbing issues

• Domestic Water: Main on street (Structure)  
pressure → nuisance alarms in buildings

• Roof in good shape; White TPO-Flat  
- haven't noticed leaks standing some metal  
elsewhere

• Football field → turf problems @ stand but  
been resolved as far as he knows.

• His guys adequately trained to work on the  
System.

• They have all the O&Ms for major systems @ distro  
office; PSFA required ~ 3 year maintenance  
contract (LINC Services)

→ District has learned how to deal w/ structures  
& replacing hwy pumps

→ more preventive maintenance

- (4) x year → Filter changes

- checking pumps, fillings,  
temperatures (water)

- Chemical work not introduced at beginning; paid  
to have it done later.

- Less work orders for this school than other schools

- Concrete/Block construction (durable)

- Roof

- Quantity all local/distributed (by control)

- Not sure if this school's exterior (by) is on district  
PK control.

→





2428 Bishop Dr. SE Albuquerque, NM 87106  
Tel: 505-241-9665 Fax: 505-241-4109  
E-mail: mhga@mhgaarchitect.com  
www.mhgaarchitect.com

Consultant  
Address  
Phone  
Fax

AS-BUILTS

PROJECT  
LAS CRUCES PUBLIC  
SCHOOLS  
NEW LAS CRUCES  
MIDDLE SCHOOL  
LAS CRUCES, NEW  
MEXICO

BID PACKAGE #3  
CONSTRUCTION  
DOCUMENTS  
08/20/2009  
P08-008

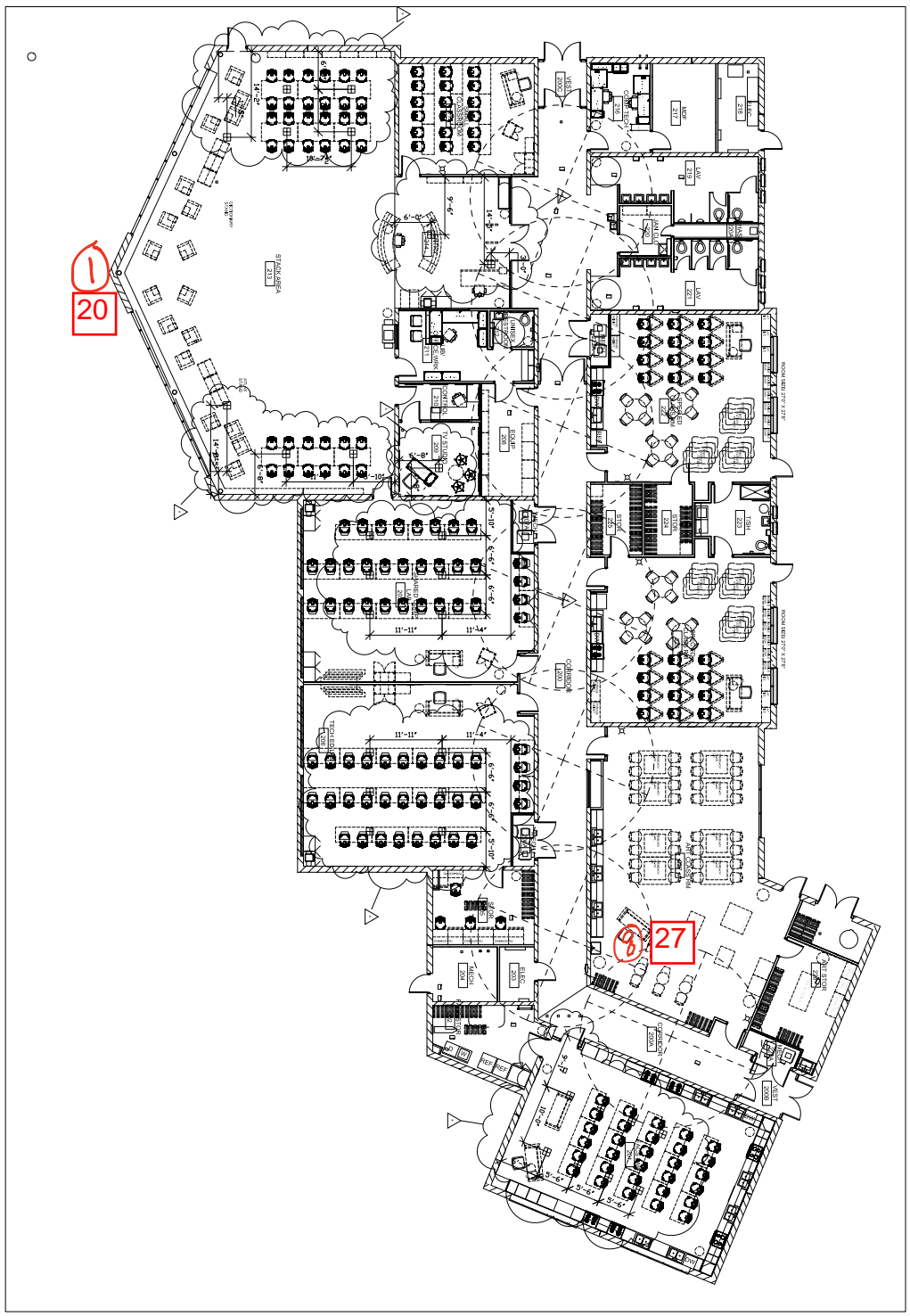
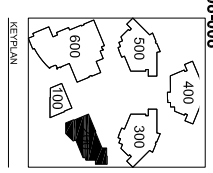

A2 FURNITURE PLAN  
Scale: 1/8" = 1'-0"

Drawn By: A/ALG  
Checked By: C/CMG  
Company: VAN H. GILBERT ARCHITECT P  
SHEET TITLE  
FURNITURE PLAN

Observation Notes **① - Library 10/21 10:43-11:10**

<p>A – Activities are goal directed set of actions – things which people want to accomplish</p>	<p>E – Environments are the entire arena where activities take place</p>	<p>I – Interactions between a person and someone else, then building blocks of activities</p>	<p>O – Objects are building blocks of the environment, key elements sometimes put to complex or unintended uses, changing their function, meaning and context</p>	<p>U – Users are the occupants, the people providing the behaviors, preferences, and needs</p>
<p><b>Kids checking out books w/ librarian</b>                      Sitting &amp; reading; some conversation                      0</p>	<ul style="list-style-type: none"> <li>• All lights on</li> <li>• Shades on view glass panel.</li> <li>• Could probably get by w/ some lights off, but not sure it's zoned.</li> <li>• Hear a slight echo from librarian's voice as she reads - slightly raising voice, but no background sound really to talk over.</li> </ul>	<p>After checking out, library librarian reading a story to students @ the roller chair area.</p>	<ul style="list-style-type: none"> <li>• Roller chairs w/ moveable work surface popular among students</li> <li>• Otherwise students sitting @ tables &amp; chairs</li> <li>• Also using computer station behind librarian</li> <li>• (14) computer stations</li> </ul>	<ul style="list-style-type: none"> <li>• Class of students</li> <li>• Librarian</li> <li>• Class teacher</li> <li>• Library Assistant?</li> </ul>



Observation Notes **B** - Art Class

<p>A – Activities are goal directed set of actions – things which people want to accomplish</p>	<p>E – Environments are the entire arena where activities take place</p>	<p>I – Interactions between a person and someone else, then building blocks of activities</p>	<p>O – Objects are building blocks of the environment, key elements sometimes put to complex or unintended uses, changing their function, meaning and context</p>	<p>U – Users are the occupants, the people providing the behaviors, preferences, and needs</p>
<p>- Started w/ some announcements of what they will be doing.                      - Then passing iPads to each group.                      - Breaking out into teams                      - Must e main tables; (2) @ small or table; (1) person e a light table; (2) people e another light table.</p>	<p>• lights e k level; washer lights off                      • Shades down over daylight portion of glazing; straightness clear view                      • Temp seems ok                      • Pull rear ss people working in their teams                      • Door open. → Floor may make it worse, but its an art room.                      • Occasionally can hear some other classroom noise in hall.                      • Turned lights off e 3:14. or was it oc. sensor?                      • Enough light e tables by window. Other tables may be too dark.                      • Adequate space footage for this number of eighth graders.</p>	<p>Student getting drink out of one of the sinks.                      End of day; some students losing focus; me too                      Having one of the light tables suffer from everything else in class staying from type e emptying.</p>	<p>iPads                      Light Tables                      (2) oc. sensors                      (3) white boards                      - All three are almost 100% covered w/ text or hangings                      Some posters are hung/typed around the room.</p>	<p>26 students                      (13) girls; (13) boys                      • Mix of short sleeve, long sleeve, pull overs                      • Mix of pants e shorts                      (1) teacher (female)</p> <hr/> <p>2:20 - Bldg 200                      (5) doors open - all rooms occupied.</p>

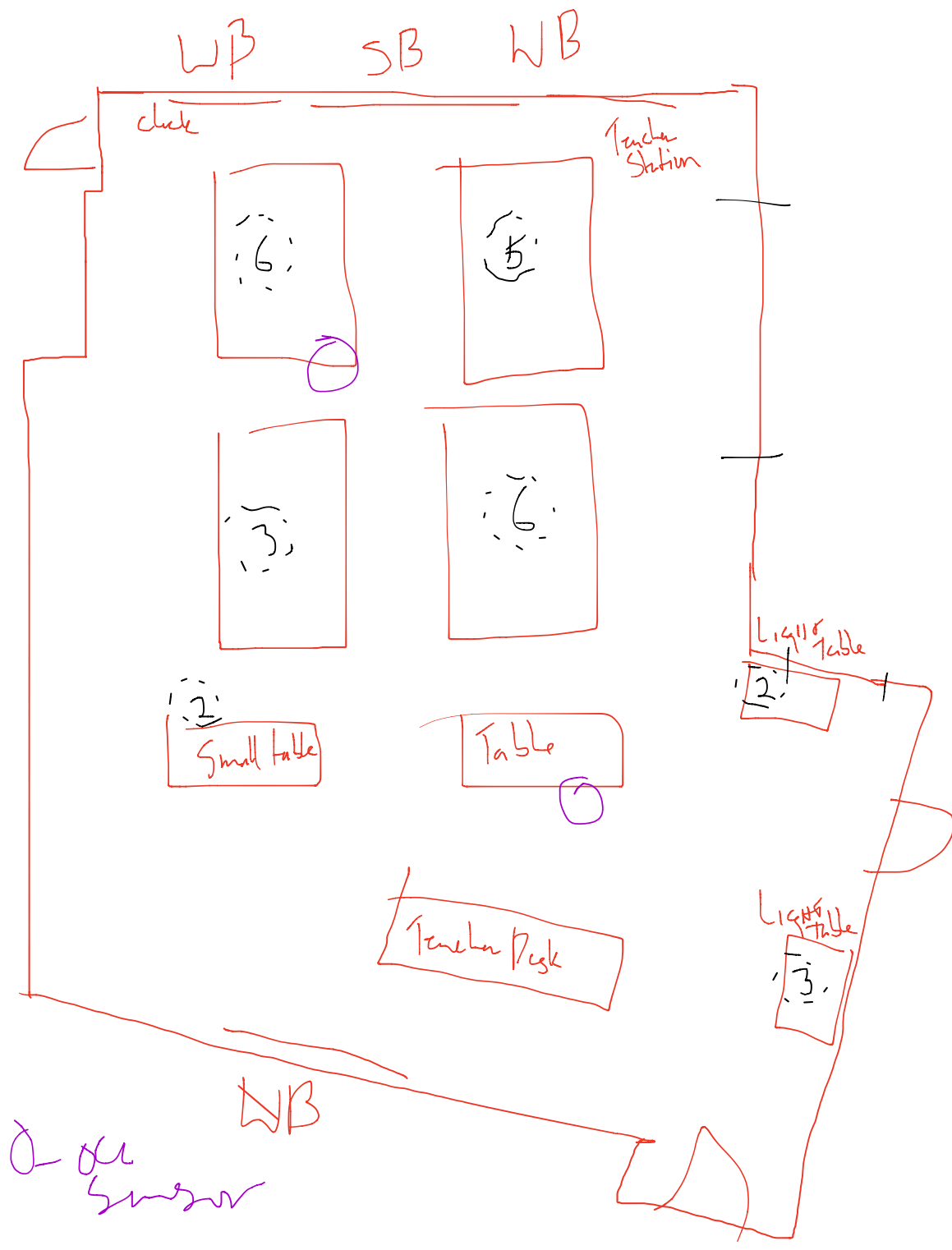



2428 Shiloh Dr SE, Albuquerque, NM 87106  
Tel: 505-241-9955 Fax: 505-241-4109  
E-mail: mhga@mhgaarchitect.com  
www.van-h-gilbert.com

Consultant  
Address  
Phone

SECTION 05200 - CASSELS  
FURNITURE AND FIXTURES - SEE SPECIFICATIONS  
FURNITURE AND FIXTURES SHALL BE PROVIDED BY THE CONTRACTOR. THE CONTRACTOR SHALL BE RESPONSIBLE FOR THE PROTECTION, STORAGE, AND DELIVERY OF ALL FURNITURE AND FIXTURES TO THE PROJECT SITE. THE CONTRACTOR SHALL BE RESPONSIBLE FOR THE PROTECTION, STORAGE, AND DELIVERY OF ALL FURNITURE AND FIXTURES TO THE PROJECT SITE. THE CONTRACTOR SHALL BE RESPONSIBLE FOR THE PROTECTION, STORAGE, AND DELIVERY OF ALL FURNITURE AND FIXTURES TO THE PROJECT SITE.

AS-BUILTS

LAS CRUCES PUBLIC  
SCHOOLS  
NEW LAS CRUCES  
MIDDLE SCHOOL  
LAS CRUCES, NEW  
MEXICO

BID PACKAGE #3  
CONSTRUCTION  
DOCUMENTS  
08/20/2009  
P08-008

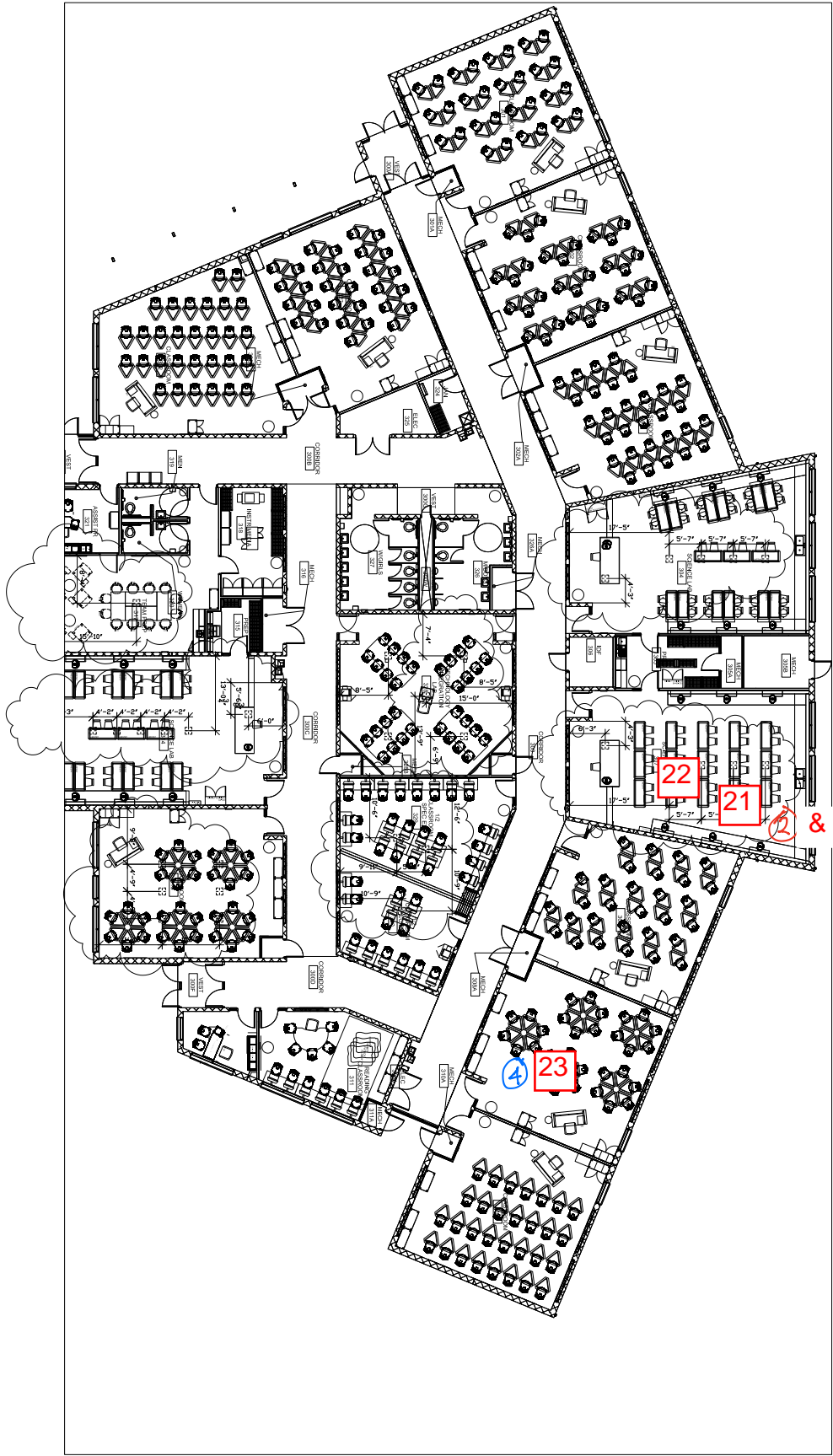
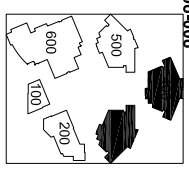

**A1** FURNITURE PLAN

Scale: 1/8" = 1'-0"

FURNITURE PLAN

Observation Notes ② 6th Grade Science Lab 8:40-9:00

<p>A – Activities are goal directed set of actions – things which people want to accomplish</p>	<p>E – Environments are the entire arena where activities take place</p>	<p>I – Interactions between a person and someone else, then building blocks of activities</p>	<p>O – Objects are building blocks of the environment, key elements sometimes put to complex or unintended uses, changing their function, meaning and context</p>	<p>U – Users are the occupants, the people providing the behaviors, preferences, and needs</p>
<p>Kids shopping parents - while teacher giving instructions - a little distracting</p>	<p>- Classroom clear open - lights on half level - shades lowered - Can hear some type of work being done outside @ driving lane. Doesn't appear to be distracting anyone. - w/ 11 kids small not loud.</p>	<p>At beginning of class giving instructions - students wheeled their chairs up to front of room.</p>	<p>Teacher using her iPad's writing on mobile whiteboard - not using smart board - didn't quite catch why</p>	<p>11 students - 4 girls, 7 boys - Mix of pull ons, long sleeve &amp; short sleeve - Mix of pants &amp; shorts (1) teacher → female</p>