

Observation Notes ③ 6th grade Science Lab 9:10-9:57

<p>A – Activities are goal directed set of actions – things which people want to accomplish</p>	<p>E – Environments are the entire arena where activities take place</p>	<p>I – Interactions between a person and someone else, then building blocks of activities</p>	<p>O – Objects are building blocks of the environment, key elements sometimes put to complex or unintended uses, changing their function, meaning and context</p>	<p>U – Users are the occupants, the people providing the behaviors, preferences, and needs</p>
<p>• Started off asking quiz type questions</p> <p>• Then giving overview of a final event @ NRSU</p> <p>• Instucting w/ the smart board.</p> <p>• Breaking up into groups</p> <p>• During small group activities teacher giving from group to group helping</p> <p>Also removing junk from sinks so they don't get clogged → pencil, gum, wrappers</p> <p>Also moving students away from sinks to avoid temptation</p>	<p>• One kid commented that work outside was pretty distracting</p> <p>• Lights half level on</p> <p>• Shades pulled down.</p> <p>• Turn lights off to use smart board</p> <ul style="list-style-type: none"> - pretty visible from back of room - Bottom of smart board isn't visible from back of room. <ul style="list-style-type: none"> - Moving up things would make it difficult to reach top of smart board for shorter teachers/students <p>Temp good though I was still cold from my observations</p>	<p>• Some kids discussing in groups of 2's or 3's</p> <p>• Sharpening pencils</p> <p>• 9:49 - Pledge of Allegiance</p> <ul style="list-style-type: none"> - Announcements - Class shuts down <p>- Teacher mainly notices kids putting stuff in the narrow black sinks and the square aluminum sinks in the back, but kids sit there too → my guess is not as frequently</p> <p style="text-align: center; border: 1px solid red; border-radius: 50%; padding: 5px;">tech problem is forming</p>	<p>Trying to use smartboard but having trouble using smart board.</p> <p>• Need more hooks on tables for backpacks & a few using the screen hang on back of chairs but teacher removed them → too heavy; afraid they would break chairs → contribute to wheel breakage?</p> <p>• Besides education technology, Not many plug loads</p> <ul style="list-style-type: none"> - Pencil sharpener - lamp <p>• Maybe a cork strip up high on back wall would help to hang things.</p> <p>• See the advantage of mobile chairs, tables, particularly combined w/ perimeter sink/ station</p> <p>Most iPads she had is 5 → put an order in to get total of 15 → good because she has 38 kids</p>	<p>(18) students; e least (1) absent</p> <ul style="list-style-type: none"> • More of pull over, jackets & sweat sleeves • Mostly pants, some shorts <p>→ Though kids sometimes use chairs as cars</p> <p>→ Makes room more flexible easier to do group activities & keep space between groups.</p>



Observation Notes (4) 7th Grade - 10:07 - 10:50

<p>A – Activities are goal directed set of actions – things which people want to accomplish</p>	<p>E – Environments are the entire arena where activities take place</p>	<p>I – Interactions between a person and someone else, then building blocks of activities</p>	<p>O – Objects are building blocks of the environment, key elements sometimes put to complex or unintended uses, changing their function, meaning and context</p>	<p>U – Users are the occupants, the people providing the behaviors, preferences, and needs</p>
<p>Teacher initially giving instruction; students @ desks Getting up to get laptops out of cart. • Drinking in small groups • Teacher going around to help students</p>	<p>• Indirect lights full on • Gyzers off • Shades pulled down on all windows • operable window shut • Door open • Towards end of class turned lights down to 1/2 level → kids were noisy & not reading quietly → assume an attempt to help calm them down. Turning them all the way off might help better. - took several minutes to get them to get a book, but still not so read quietly → not complete success. When everyone was quiet could hear a little noise in corridor.</p>	<p>(1) student came in from another class to return a leg bag. But not that distracting for small groups. Small group discuss, on occasion get noisy → sound probably goes out in corridor some. - Wonder if CHU in, any doors w/ anti q.m.t. i.e. Coating (?) see better & controlling sound? Hard classroom. Floors not as good for sound control</p>	<p>Besides education technology not many plug loads observed - pencil sharpener Plug load contribution to H:IP schools should be considered; generally more high-tech equipment than other schools Desks appear to be big enough when pushed together for students to have laptops, books, notebooks on them. Separated may not necessarily be the case. Didn't see any of students hanging backpacks on hooks → hanging on back of chair or on floor → can be a tripping hazard or get in the way of moving class tables Definitely easier to move chair around to get through the class</p>	<p>18 Students • (13) girls (5) boys • Mix of jackets, pull overs, shortsleeve • Mix of jeans & shorts • (1) adult teacher leader</p> <hr/> <p>By 4:00 → 10:50 • (4) doors open (though not every row occupied)</p>

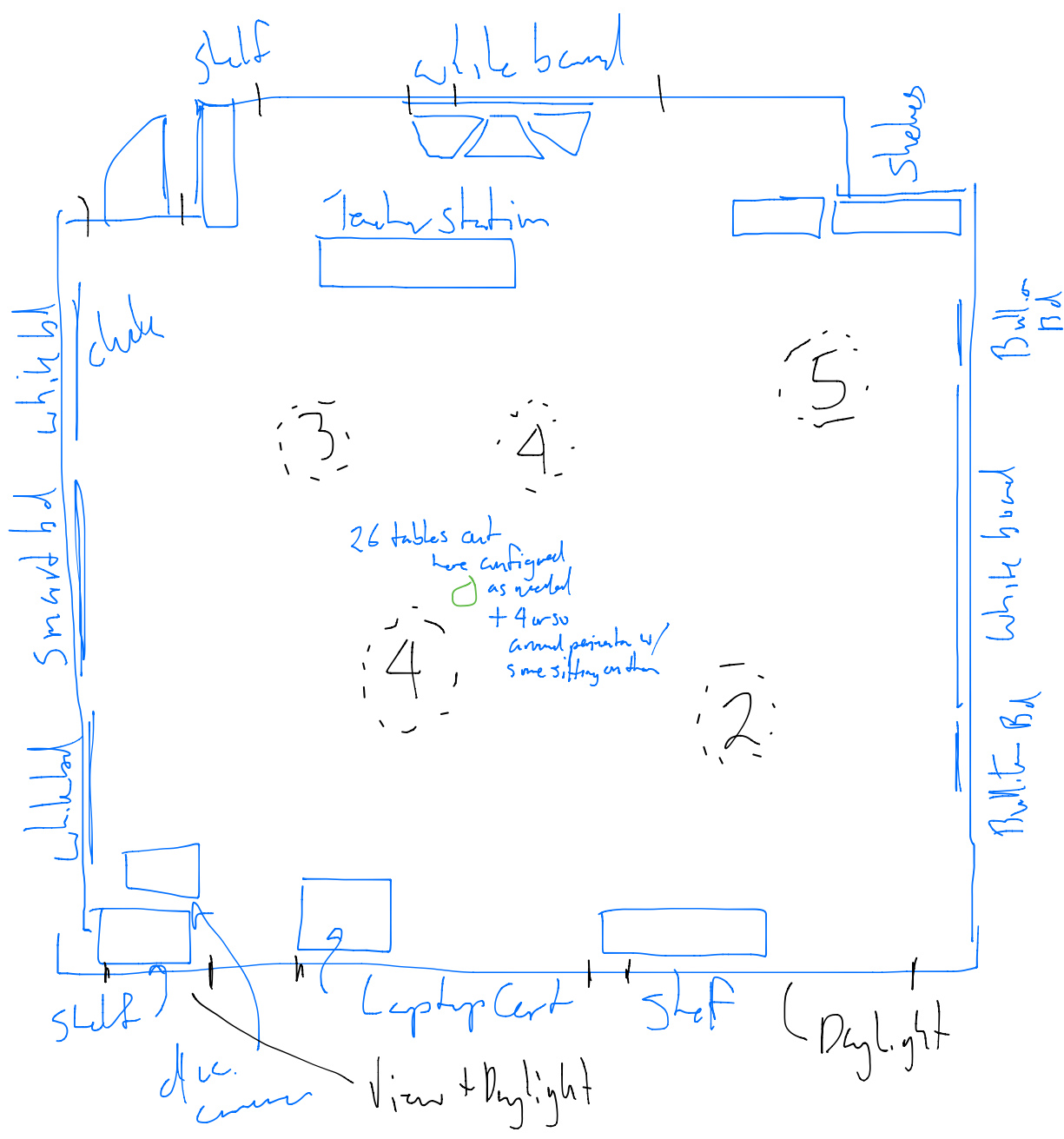

O- oa Sensor



2428 Shaw Dr SE, Albuquerque, NM 87106
Tel: 505-241-9665 Fax: 505-241-4109
E-mail: mhga@mhgaarchitect.com
www.vanhgilbert.com

Consultant
Address
Phone

SECTION 05200 - CASSELS
FURNITURE AND FIXTURES
FURNITURE AND FIXTURES SHALL BE PROVIDED BY THE CONTRACTOR. THE CONTRACTOR SHALL BE RESPONSIBLE FOR THE SELECTION OF THE FURNITURE AND FIXTURES. THE CONTRACTOR SHALL BE RESPONSIBLE FOR THE DELIVERY, INSTALLATION, AND MAINTENANCE OF THE FURNITURE AND FIXTURES. THE CONTRACTOR SHALL BE RESPONSIBLE FOR THE PROTECTION OF THE FURNITURE AND FIXTURES DURING CONSTRUCTION. THE CONTRACTOR SHALL BE RESPONSIBLE FOR THE REMOVAL OF THE FURNITURE AND FIXTURES AT THE END OF THE PROJECT. THE CONTRACTOR SHALL BE RESPONSIBLE FOR THE REPAIR OF ANY DAMAGE TO THE FURNITURE AND FIXTURES. THE CONTRACTOR SHALL BE RESPONSIBLE FOR THE PROTECTION OF THE FURNITURE AND FIXTURES DURING CONSTRUCTION. THE CONTRACTOR SHALL BE RESPONSIBLE FOR THE REMOVAL OF THE FURNITURE AND FIXTURES AT THE END OF THE PROJECT. THE CONTRACTOR SHALL BE RESPONSIBLE FOR THE REPAIR OF ANY DAMAGE TO THE FURNITURE AND FIXTURES.

AS-BUILTS

LAS CRUCES PUBLIC
SCHOOLS
NEW LAS CRUCES
MIDDLE SCHOOL
LAS CRUCES, NEW
MEXICO

BID PACKAGE #3
CONSTRUCTION
DOCUMENTS
08/20/2009
P08-008

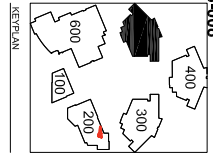

KEY PLAN

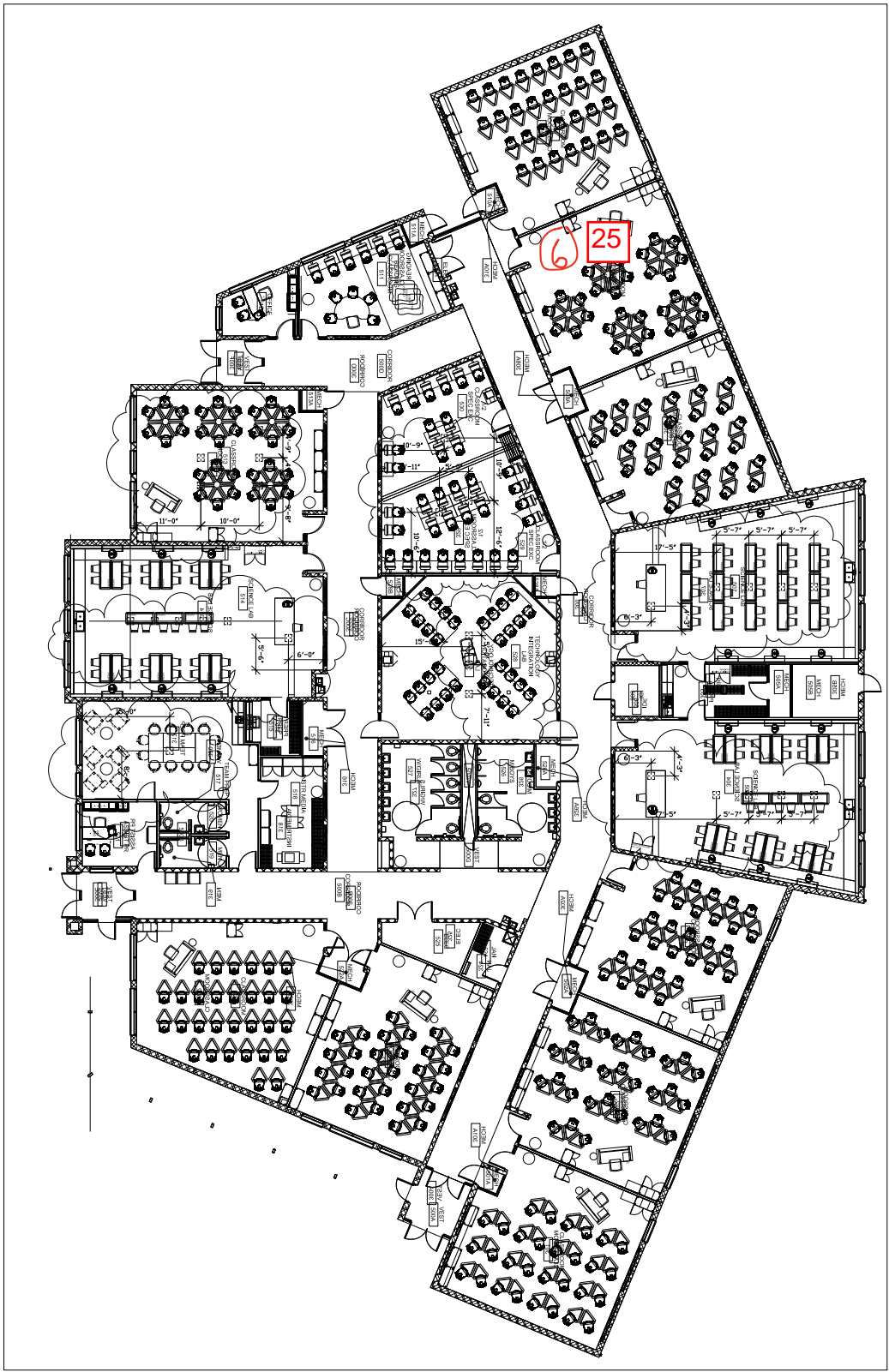

A1 FURNITURE PLAN
Scale: 1/8" = 1'-0"

FURNITURE PLAN

NO.	DATE	DESCRIPTION	BY
1	08/20/09	ISSUED FOR BIDDING	STAFF
2	08/20/09	ISSUED FOR BIDDING	STAFF
3	08/20/09	ISSUED FOR BIDDING	STAFF
4	08/20/09	ISSUED FOR BIDDING	STAFF
5	08/20/09	ISSUED FOR BIDDING	STAFF
6	08/20/09	ISSUED FOR BIDDING	STAFF
7	08/20/09	ISSUED FOR BIDDING	STAFF
8	08/20/09	ISSUED FOR BIDDING	STAFF
9	08/20/09	ISSUED FOR BIDDING	STAFF
10	08/20/09	ISSUED FOR BIDDING	STAFF

Checked By: VAN H. GILBERT ARCHITECT P
Company: VAN H. GILBERT ARCHITECT P
Staff: STAFF

Observation Notes

6 - 4th grade 12:40

<p>A – Activities are goal directed set of actions – things which people want to accomplish</p>	<p>E – Environments are the entire arena where activities take place</p>	<p>I – Interactions between a person and someone else, then building blocks of activities</p>	<p>O – Objects are building blocks of the environment, key elements sometimes put to complex or unintended uses, changing their function, meaning and context</p>	<p>U – Users are the occupants, the people providing the behaviors, preferences, and needs</p>
<p>Teaching students lecture style using smart board.</p> <p>Then played a story on sound system accessed through control on cart w/ document camera.</p> <p>Then instructing on during an exercise.</p>	<p>Lights all off to use smartboard</p> <p>Daylight windows; shades up</p> <ul style="list-style-type: none"> Daylight/View glass: shades half up Windows closed. Temp a little warm → maybe air a little stale. Plus front wash lights on Barely hear some corridor noise when audio plays (voice pauses). Sound system audio clear - easily heard by everyone. Lights stayed off the rest of the time; probably helped everyone calm down. Air kicked on at some point - very quiet but cooler & not as stale Visually able to hide from corridor's outside during lock down situation 	<p>Teacher lecturing to students & asking them questions</p> <p>Playing a story on sound system.</p> <ul style="list-style-type: none"> Some discuss in among students, & some class, but not very loud. 	<p>28 students w/ tables. Configuration the way it is make it a little difficult to traverse class, though teacher manages.</p> <ul style="list-style-type: none"> Backpacks either hung on chair or on floor, didn't notice any hanging on hook. Didn't notice many plug loads besides ed tech: <ul style="list-style-type: none"> Sharpener Phone 	<ul style="list-style-type: none"> 28 students (16) girls (12) boys Mix of short sleeves & long sleeves Mix of pants & shorts (1) adult female Pretty tight w/ this number of students. <hr/> <p>→ 1:20 - BLM 560</p> <p>6 doors open</p> <p>not any room occupied</p> <ul style="list-style-type: none"> Corridor is a little crowded next to RR/donkey fountain Teachers talking/collaborating in corridor between classes

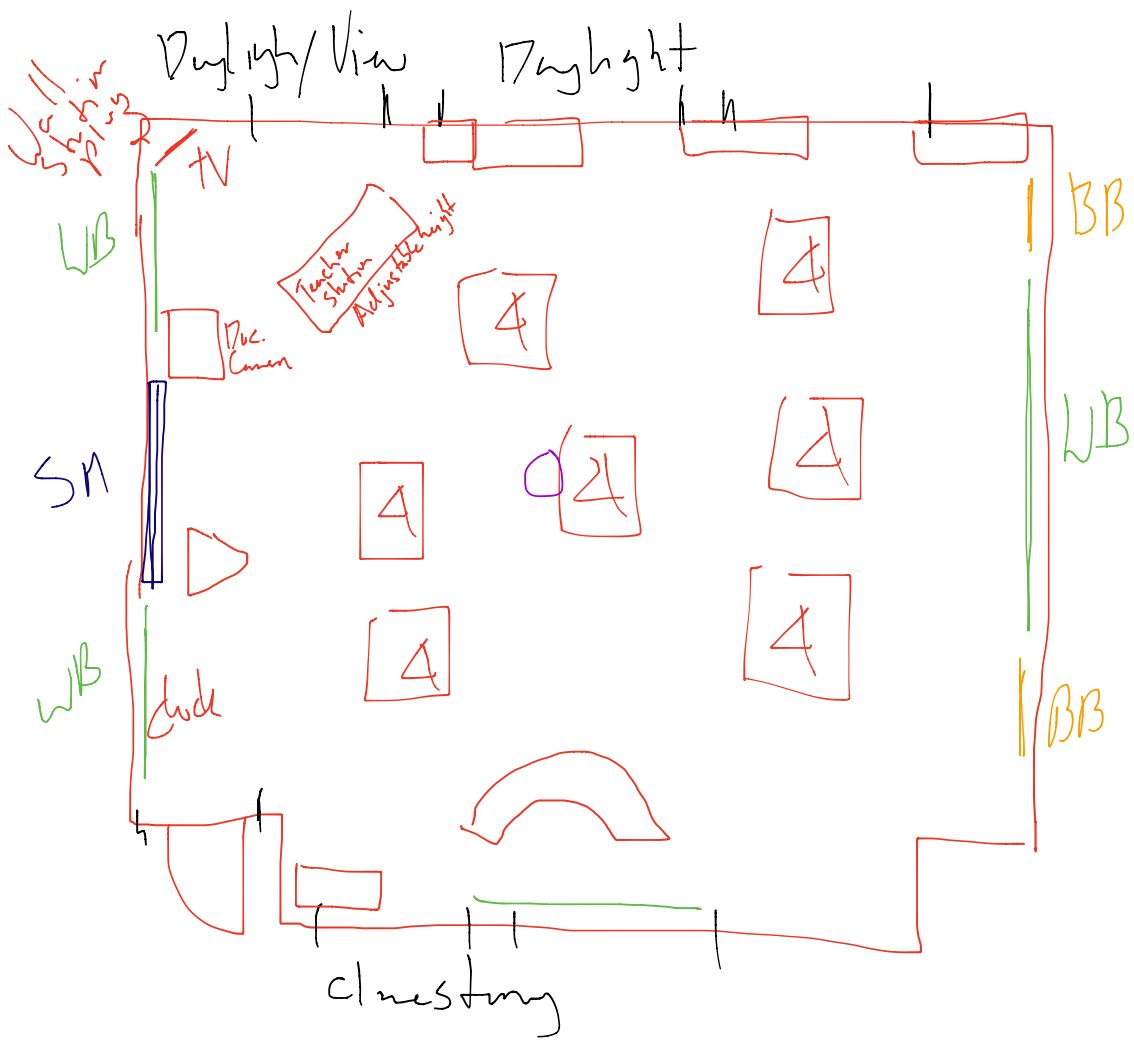

4 - 4 triangle tables together
O - OCC. sensor
⌋ pattern



2428 Shawler Dr. SE Albuquerque, NM 87106
Tel: 505-241-9665 Fax: 505-241-4108
E-mail: mhga@mgarchitect.com
www.vanhgilbert.com

Consultant
Address
Address
Address
Phone

SECTION DETAILS
AS-BUILT
MESA MIDDLE SCHOOL
LAS CRUCES, NM
MEXICO

AS-BUILT
MESA MIDDLE SCHOOL
LAS CRUCES, NM
MEXICO

BID PACKAGE #3
CONSTRUCTION DOCUMENTS
08/20/2009
P08-008

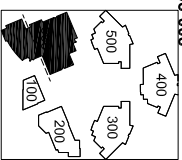

AS-BUILT

FURNITURE PLAN

Scale: 3/32" = 1'-0"

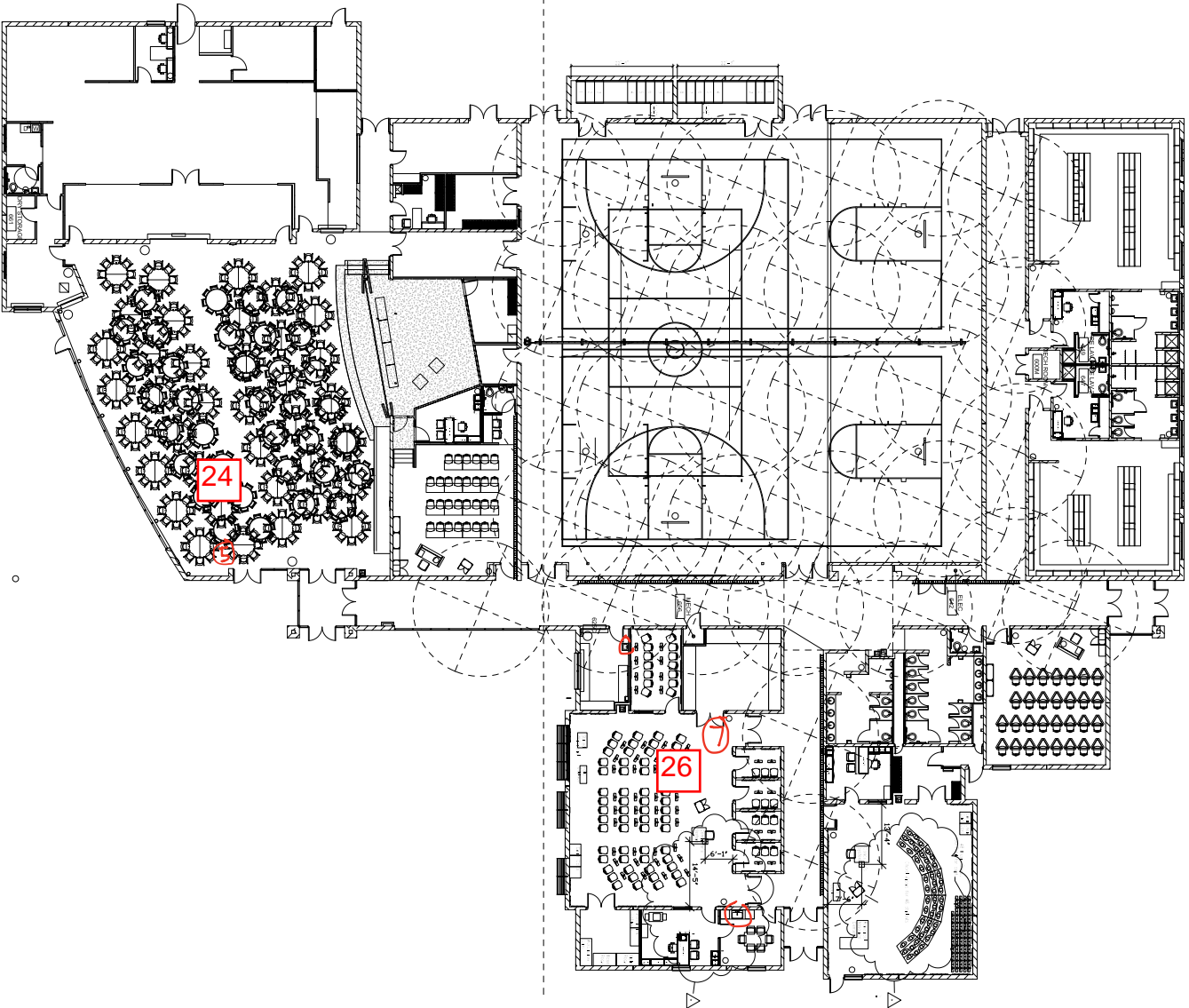

FURNITURE PLAN

Observation Notes (5) - *Celebration: 11:45 -*

<p>A – Activities are goal directed set of actions – things which people want to accomplish</p>	<p>E – Environments are the entire arena where activities take place</p>	<p>I – Interactions between a person and someone else, then building blocks of activities</p>	<p>O – Objects are building blocks of the environment, key elements sometimes put to complex or unintended uses, changing their function, meaning and context</p>	<p>U – Users are the occupants, the people providing the behaviors, preferences, and needs</p>
<p>Mostly full w/ kids eating @ 11:40. By 11:55, most kids eat → @ kitchen staff cleaning tables. All gone by noon.</p> <hr/> <p>Shortly after 12:00, next wave comes in.</p> <p>① - (2) rough primary "lines" from ①b - (2) smaller lines from ② - Another food station "junk food"?? ③ - Parents on table seating - Some congestion w/ line @ ②</p> <p>Students leaving by 12:15 starting to wipe tables by 12:15</p>	<p>There are motorized shades on the windows; drop in morning to keep sun/heat out; Parkers space enough to use projector</p> <ul style="list-style-type: none"> • Lights are all on; wouldn't need all of them on. • Temperature comfortable - I have long sleeve shirt on. • Some acoustical treatment on west & south walls • Sound isn't bad w/ anyone inside loud but not overly so. 	<p>Serve breakfast & lunch in here</p> <ul style="list-style-type: none"> • Students talking w/ each other @ tables. • Great interaction between students & teaching staff including security <p>→ round tables seem to help facilitate this.</p>	<p>28 tables inside; 10 tables outside</p> <p>Not overly crowded w/ 28 tables → tight but you can get around.</p> <p>→ + (1) on stage</p>	<p>Assistant Principals (2) Security Officer (1) Kitchen Staff (4) to (5) Custodian (1) Students</p> <p><i>Videos cameras</i></p> <p><i>Drum Club has do plugs on stage</i></p>



Observation Notes ⑦ - Band Room 1:39

<p>A – Activities are goal directed set of actions – things which people want to accomplish</p>	<p>E – Environments are the entire arena where activities take place</p>	<p>I – Interactions between a person and someone else, then building blocks of activities</p>	<p>O – Objects are building blocks of the environment, key elements sometimes put to complex or unintended uses, changing their function, meaning and context</p>	<p>U – Users are the occupants, the people providing the behaviors, preferences, and needs</p>
<p>Practicing playing as a band. - practicing some for football game today. Practicing on own briefly while she was writing some notes</p> <ul style="list-style-type: none"> • Afterwards, engine & other items w/ cases for instruments • Take care of percussion - With multiple items to store instruments in → end of class flows pretty well - line up @ exit to line 	<p>Daylight glass w/ shades down. → lead</p> <ul style="list-style-type: none"> • Individual Percussion on. Master light's off • Maybe some would be off • Acoustic Clg Panel + Special Panels - Clg + Panels on wall around room perimeter. Carpet - Takes a lot of the work out on art. Temp. ok, but maybe slightly warm - slightly stale, slight odor - everyone practicing on their own Very noisy practicing on own. - good idea locating choir, band & gym in same bldg. 	<p>• Can hear teacher fine w/out using sound system.</p> <p>Teacher instructing from front, directing them. Periodically breaking off to work w/ (1) or (2) students</p> <p>Teacher commented that it was hot in room.</p> <p>* Exterior light shades are helping.</p>	<p>Backpacks around room perimeter on floor; some instrument cases</p> <ul style="list-style-type: none"> - most in surround my practice (?) rooms chairs don't have rollers on them. (2) occupancy sensors for room (1) drinking fountain (1) power & (1) cable outlet high on east wall. Why? Projector Screen is on the same wall as the daylight glass. possible that contrast issues result even w/ shades down. Furniture & Percussion Equip. & Instruments look in good shape. Outlets all around perimeter of room. light switches @ each entrance Size of classroom seems appropriate. 	<p>40 students 16 girls 24 boys mix of short shoes, long shoes & pull ups → some final around week 1 teacher - female</p>

Observation Notes **DISMISSAL 10/21; 3:30-3:40**

<p>A – Activities are goal directed set of actions – things which people want to accomplish</p>	<p>E – Environments are the entire arena where activities take place</p>	<p>I – Interactions between a person and someone else, then building blocks of activities</p>	<p>O – Objects are building blocks of the environment, key elements sometimes put to complex or unintended uses, changing their function, meaning and context</p>	<p>U – Users are the occupants, the people providing the behaviors, preferences, and needs</p>
<p>• Observed the bus pickup side • Went very smooth • According to security officer no traffic issues</p>	<p>• Walked out to football field w/ security officer • Not a great shape grass & poor visibility whenever sun here • Stands on east side in shade of west → catch setting sun Security fence has some gaps → wild dogs & coyotes get in → safety concern.</p>	<p>Students hanging around a little jockey w/ security officer</p>	<p>Buses – must park on diagonal, some lineup on curb</p>	<p>Security officer Law Enforces assigned Police officer Bus Drivers Students leaving</p>

Observation Notes

<p>A – Activities are goal directed set of actions – things which people want to accomplish</p>	<p>E – Environments are the entire arena where activities take place</p>	<p>I – Interactions between a person and someone else, then building blocks of activities</p>	<p>O – Objects are building blocks of the environment, key elements sometimes put to complex or unintended uses, changing their function, meaning and context</p>	<p>U – Users are the occupants, the people providing the behaviors, preferences, and needs</p>
<p>② 7:45 Watching teacher/staff come in & parents drop students off - some parents dropping off in front staff/visitor parking (driving through)</p> <p>③ 8:00 - 8:14 Parents dropping students off @ east gate.</p> <p>④ 8:15 - Students in interior courtyard. - Playing BBS, talking in groups, checking phones - some coming in from cafeteria @ 8:15-2:00</p>	<p>Low sun is bright Most kids trying to stay in sun Rocks are a hazard playing ball or horsing around. Sidewalk layout doesn't necessarily correspond to where people naturally want to walk.</p> <p>⑤ Kids coming in west gate from buses</p>	<p>Dropping off is very smooth - Observed one taking almost (1) minute (commuting), but most last < 10-20s Most cars observed parked: 6 Most cars observed in lane: 8 A few impatient parents would pull out from behind local cars after dropping off kids but must wait in line</p>	<p>Noticed a bus pulling in by a little after 8:00 Another by 8:10 " " 8:12 " " 8:14 ④ - pile of instruments outside music room</p>	<p>Teachers /st aff coming to work - some go in through office/admin. lobby; some go in through gate. Students who are before 8:00 have to wait in a teacher entryway lobby or lobby in front outside. Some could walk through gate but I didn't observe this. Saw (3) kids walking into Campus, but not sure where they came from. ④ - Mesh kids in pull over's & pants; some in shorts, some in slouch shoes</p>

Observation Notes ⑤ 10/22 Dismissal

<p>A – Activities are goal directed set of actions – things which people want to accomplish</p>	<p>E – Environments are the entire arena where activities take place</p>	<p>I – Interactions between a person and someone else, then building blocks of activities</p>	<p>O – Objects are building blocks of the environment, key elements sometimes put to complex or unintended uses, changing their function, meaning and context</p>	<p>U – Users are the occupants, the people providing the behaviors, preferences, and needs</p>
<p>Only takes a couple of minutes & they're cleaned through the courtyard</p>	<p>Sidewalks don't completely match actual traffic patterns; particularly when students are in mass.</p>	<p>Football players throwing football around BD what as they're walking through → in the peds & bt.</p>		

17. Appendix F: Energy and Water Performance Data

District	Middle School	#	Climate Zone	Grades	Site Size (Acres)	Square Footage/Enrollment				
District	Middle School	#	Climate Zone	Grades	Site Size (Acres)	Total Sq. Ft.	Perm. Sq. Ft.	Port. Sq. Ft.	% Port. Sq. Ft.	Enrollment
Alam.	Chaparral Middle School R	1	3	6-8	40	117335	114101	3234	2.76%	675
Alam.	Mountain View Middle School	2	3	6-8	40	92934	92038	896	0.96%	408
Deming	Red Mountain MS	3	3	6-8	26.75	125928	125928	0	0.00%	794
Dexter	Dexter MS	4	3	6-8	13	42462	42462	0	0.00%	221
Gadsden	Chaparral MS	5	3	6-8	20	93937	85681	8256	8.79%	550
Gadsden	Gadsden MS	6	3	6-8	21.2	166310	164870	1440	0.87%	788
Gadsden	Santa Teresa MS	7	3	6-8	48	132268	127244	5024	3.80%	688
Hatch	Hatch Valley MS	8	3	6-8	20	70024	64984	5040	7.20%	309
Las Cruces	Camino Real MS	9	3	6-8	45.76	115817	114921	896	0.77%	636
Las Cruces	Lynn MS	10	3	6-8	17	113823	110239	3584	3.15%	817
Las Cruces	Mesa MS	11	3	6-8	18	112428	112428	0	0.00%	628
Las Cruces	Picacho MS	12	3	6-8	20	128314	124474	3840	2.99%	839
Las Cruces	Sierra MS	13	3	6-8	22	96249	96249	0	0.00%	820
Las Cruces	Vista MS	14	3	6-8	18	96438	96438	0	0.00%	725
Las Cruces	Zia MS	15	3	6-8	15	112360	110824	1536	1.37%	820
Lordsburg	Dugan Tarango MS	16	3	6-8	24.1	43552	43552	0	0.00%	76
Roswell	Berrendo MS	17	3	6-8	19.22	108235	98835	9400	8.68%	660
Roswell	Mesa MS	18	3	6-8	13.58	80242	74866	5376	6.70%	457
Roswell	Mountain View MS	19	3	6-8	13.89	65802	64010	1792	2.72%	486
Roswell	Sierra MS	20	3	6-8	11.77	109940	101892	8048	7.32%	615
Ruidoso	Ruidoso MS	21	3	6-8	13.1	70000	70000	0	0.00%	496
APS	Cleveland MS	22	4	6-8	12	111071	95391	15680	14.12%	667

APS	Desert Ridge MS	23	4	6-8	25	169297	158545	1075 2	6.35%	1047
APS	Eisenhower MS	24	4	6-8	20	135982	123438	1254 4	9.22%	885
APS	Ernie Pyle MS	25	4	6-8	18.5	120629	115365	5264	4.36%	654
APS	Garfield MS	26	4	6-8	14.7	100688	93408	7280	7.23%	346
APS	Grant MS	27	4	6-8	22	122468	109924	1254 4	10.24 %	634
APS	Harrison MS	28	4	6-8	10.16	123861	101797	2206 4	17.81 %	921
APS	Hayes MS	29	4	6-8	15.5	108635	95191	1344 4	12.38 %	373
APS	Hoover MS	30	4	6-8	17	113740	105900	7840	6.89%	684
APS	Jackson MS	31	4	6-8	18	88993	77793	1120 0	12.59 %	607
APS	James Monroe MS	32	4	6-8	20	182241	149089	3315 2	18.19 %	972
APS	Jefferson MS	33	4	6-8	14	125678	119406	6272	4.99%	927
APS	Jimmy Carter MS	34	4	6-8	19	149859	119395	3046 4	20.33 %	1229
APS	John Adams MS	35	4	6-8	19.89	127430	106642	2078 8	16.31 %	703
APS	Kennedy MS	36	4	6-8	21	103492	96324	7168	6.93%	501
APS	Lyndon B. Johnson MS	37	4	6-8	60	154635	145675	8960	5.79%	914
APS	Madison MS	38	4	6-8	19.97	129662	120142	9520	7.34%	732
APS	McKinley MS	39	4	6-8	16	100137	82329	1780 8	17.78 %	576
APS	Polk MS	40	4	6-8	20	96249	85749	1050 0	10.91 %	459
APS	Roosevelt MS	41	4	6-8	11.2	105583	101999	3584	3.39%	360
APS	Taft MS	42	4	6-8	21	146304	127488	1881 6	12.86 %	524
APS	Taylor MS	43	4	6-8	20.5	108601	98745	9856	9.08%	510
APS	Tony Hillerman MS	44	4	6-8	0	150740	150740	0	0.00%	913
APS	Truman MS	45	4	6-8	21.11	190905	150249	4065 6	21.30 %	1394
APS	Van Buren MS	46	4	6-8	20	113830	107558	6272	5.51%	531
APS	Washington MS	47	4	6-8	13	95766	92182	3584	3.74%	464
APS	Wilson MS	48	4	6-8	15	94841	94841	0	0.00%	516
Bernalillo	Bernalillo MS	49	4	6-8	14.28	106109	104317	1792	1.69%	442
Cobre	Snell MS	50	4	6-8	16.42	92859	92859	0	0.00%	188

Los Lunas	Los Lunas MS	51	4	6-8	14.27	103929	103929	0	0.00%	732
Portales	Portales Jr HS	52	4	6-8	20	96358	96358	0	0.00%	453
Santa Rosa	Santa Rosa MS	53	4	6-8		49700	49700	0	0.00%	120
Socorro	Raymond Sarracino MS	54	4	6-8	30.73	90514	88722	1792	1.98%	351
TorC	Truth or Consequences MS	55	4	6-8	25	67170	65378	1792	2.67%	300

District	Middle School	#	2012-2013 Energy Values					
District	Middle School	#	Electric (KBTU)	Gas (KBTU)	Total Energy (KBTU)	Total Energy EUI	Estimated Portable KBTU	Estimated Permanent KBTU
Alam.	Chaparral Middle School R	1	4278689	10467	4289156	36.55	117930	4171226
Alam.	Mountain View Middle School	2	1225095	12522	1237617	13.32	11811	1225806
Deming	Red Mountain MS	3	2576303	562000	3138303	24.92	0	3138303
Dexter	Dexter MS	4	542121	580200	1122321	26.43	0	1122321
Gadsden	Chaparral MS	5	1176847	1883300	3060147	32.58	136843	2923304
Gadsden	Gadsden MS	6	2523742	3374800	5898542	35.47	23868	5874674
Gadsden	Santa Teresa MS	7	1975084	771700	2746784	20.77	83273	2663511
Hatch	Hatch Valley MS	8	817686	1837800	2655486	37.92	83538	2571948
Las Cruces	Camino Real MS	9	2109727	1204000	3313727	28.61	14851	3298876
Las Cruces	Lynn MS	10	2798410	1483000	4281410	37.61	59405	4222005
Las Cruces	Mesa MS	11	3617876	436000	4053876	36.06	0	4053876
Las Cruces	Picacho MS	12	2265116	1815000	4080116	31.80	63648	4016468
Las Cruces	Sierra MS	13	2483650	1276000	3759650	39.06	0	3759650
Las Cruces	Vista MS	14	2202274	1543000	3745274	38.84	0	3745274
Las Cruces	Zia MS	15	2495640	1471900	3967540	35.31	25459	3942081
Lordsburg	Dugan Tarango MS	16	651132	6023100	6674232	153.25	0	6674232
Roswell	Berrendo MS	17	1953621	938300	2891921	26.72	155805	2736116
Roswell	Mesa MS	18	888795	835500	1724295	21.49	89107	1635187
Roswell	Mountain View MS	19	856345	2038500	2894845	43.99	29702	2865143

Roswell	Sierra MS	20	1857638	1459300	3316938	30.17	133396	3183542
Ruidoso	Ruidoso MS	21	2132871	1837800	3970671	56.72	0	3970671
APS	Cleveland MS	22	1604457	5447000	7051457	63.49	259896	6791561
APS	Desert Ridge MS	23	3549992	7191000	10740992	63.44	178214	10562777
APS	Eisenhower MS	24	2480081	5368000	7848081	57.71	207917	7640164
APS	Ernie Pyle MS	25	2967082	6250000	9217082	76.41	87251	9129831
APS	Garfield MS	26	1441561	4598000	6039561	59.98	120666	5918895
APS	Grant MS	27	2164935	5451000	7615935	62.19	207917	7408019
APS	Harrison MS	28	2198784	5818000	8016784	64.72	365711	7651073
APS	Hayes MS	29	1862483	4542000	6404483	58.95	222834	6181649
APS	Hoover MS	30	4025511	8899000	12924511	113.63	129948	12794563
APS	Jackson MS	31	1332598	4428000	5760598	64.73	185640	5574958
APS	James Monroe MS	32	3023157	7336000	10359157	56.84	549494	9809663
APS	Jefferson MS	33	2266569	5364000	7630569	60.72	103958	7526611
APS	Jimmy Carter MS	34	3877830	8260000	12137830	81.00	504941	11632889
APS	John Adams MS	35	2208140	5716000	7924140	62.18	344561	7579579
APS	Kennedy MS	36	1998150	4455000	6453150	62.35	118810	6334340
APS	Lyndon B. Johnson MS	37	6474879	7297000	13771879	89.06	148512	13623367
APS	Madison MS	38	2192232	5313000	7505232	57.88	157794	7347438
APS	McKinley MS	39	1807752	5146000	6953752	69.44	295168	6658585
APS	Polk MS	40	1959388	6950000	8909388	92.57	174038	8735350
APS	Roosevelt MS	41	1287879	5967000	7254879	68.71	59405	7195474
APS	Taft MS	42	2474010	6068000	8542010	58.39	311875	8230135
APS	Taylor MS	43	1821981	7182000	9003981	82.91	163363	8840618
APS	Tony Hillerman MS	44	6211462	10030000	16241462	107.74	0	16241462
APS	Truman MS	45	3417328	5088000	8505328	44.55	673873	7831454
APS	Van Buren MS	46	2055201	5127000	7182201	63.10	103958	7078242
APS	Washington MS	47	2087548	3279000	5366548	56.04	59405	5307143
APS	Wilson MS	48	1534099	6369000	7903099	83.33	0	7903099
Bernalillo	Bernalillo MS	49	1456029	4125000	5581029	52.60	29702	5551326
Cobre	Snell MS	50	2424811	417900	2842711	30.61	0	2842711
Los Lunas	Los Lunas MS	51	3077451	4063000	7140451	68.71	0	7140451
Portales	Portales Jr HS	52	1897423	2299800	4197223	43.56	0	4197223
Santa Rosa	Santa Rosa MS	53	846006	3892316	4738322	95.34	0	4738322

Socorro	Raymond Sarracino MS	54	3266047	0	3266047	36.08	29702	3236345
TorC	Truth or Consequences MS	55	700908	1206100	1907008	28.39	29702	1877306

District	Middle School	#	2012-2013 Water Values						
District	Middle School	#	Water/ Sewer (gal)	Irr. (gal)	Total Water (gal)	Water/ Sewer WUI	Irr. WUI (Site)	Total Water WUI (Building)	Total Water WUI (Site)
Alamogordo	Chaparral Middle School R	1	1374172	8243667	9617839	11.71	4.73	81.97	5.52
Alamogordo	Mountain View Middle School	2	372522		372522	4.01	0.00	4.01	0.21
Deming	Red Mountain MS	3	2231		2231	0.02		0.02	0.02
Dexter	Dexter MS	4	130000		130000	3.06		3.06	3.06
Gadsden	Chaparral MS	5	6376		6376	0.07		0.07	0.07
Gadsden	Gadsden MS	6	-		0			0.00	
Gadsden	Santa Teresa MS	7	215		215	0.00		0.00	
Hatch	Hatch Valley MS	8	655000		655000	9.35		9.35	0.75
Las Cruces	Camino Real MS	9	10,318,000	824,000	11142000	89.09	0.41	96.20	5.59
Las Cruces	Lynn MS	10	11,124,000		11124000	97.73		97.73	15.02
Las Cruces	Mesa MS	11	21,616,000		21616000	192.27		192.27	27.57
Las Cruces	Picacho MS	12	769,000	25,742,000	26511000	5.99	29.55	206.61	30.43
Las Cruces	Sierra MS	13	3,322,000	11,672,000	14994000	34.51	12.18	155.78	15.65
Las Cruces	Vista MS	14	793,000		793000	8.22		8.22	1.01
Las Cruces	Zia MS	15	4,048,000		4048000	36.03		36.03	6.20
Lordsburg	Dugan Tarango MS	16	1364		1364	0.03		0.03	0.00
Roswell	Berrendo MS	17	4760		4760	0.04		0.04	0.01
Roswell	Mesa MS	18	5567		5567	0.07		0.07	0.01
Roswell	Mountain View MS	19	9142		9142	0.14		0.14	0.02
Roswell	Sierra MS	20	4587		4587	0.04		0.04	0.01
Ruidoso	Ruidoso MS	21	928633		928633	13.27		13.27	1.63
APS	Cleveland MS	22	2204856		2204856	19.85		19.85	4.22
APS	Desert Ridge MS	23	1371164		1371164	8.10		8.10	1.26

APS	Eisenhower MS	24	8773292		8773292	64.52		64.52	10.07
APS	Ernie Pyle MS	25	6862638		6862638	56.89		56.89	8.52
APS	Garfield MS	26	1655324		1655324	16.44		16.44	2.59
APS	Grant MS	27	4152896		4152896	33.91		33.91	4.33
APS	Harrison MS	28	1390331		1390331	11.22		11.22	3.14
APS	Hayes MS	29	813076		813076	7.48		7.48	1.20
APS	Hoover MS	30	1235144		1235144	10.86		10.86	1.67
APS	Jackson MS	31	7298236		7298236	82.01		82.01	9.31
APS	James Monroe MS	32	1511732		1511732	8.30		8.30	1.74
APS	Jefferson MS	33	5791764		5791764	46.08		46.08	9.50
APS	Jimmy Carter MS	34	4185060		4185060	27.93		27.93	5.06
APS	John Adams MS	35	3320372		3320372	26.06		26.06	3.83
APS	Kennedy MS	36	1791460		1791460	17.31		17.31	1.96
APS	Lyndon B. Johnson MS	37	1076372		1076372	6.96		6.96	0.41
APS	Madison MS	38	1598826		1598826	12.33		12.33	1.84
APS	McKinley MS	39	3445288		3445288	34.41		34.41	4.94
APS	Polk MS	40	790100		790100	8.21		8.21	0.91
APS	Roosevelt MS	41	422000		422000	4.00		4.00	0.86
APS	Taft MS	42	4708408		4708408	32.18		32.18	5.15
APS	Taylor MS	43	833272		833272	7.67		7.67	0.93
APS	Tony Hillerman MS	44	2389112		2389112	15.85		15.85	
APS	Truman MS	45	1142944		1142944	5.99		5.99	1.24
APS	Van Buren MS	46	6619052		6619052	58.15		58.15	7.60
APS	Washington MS	47	7234656		7234656	75.55		75.55	12.78
APS	Wilson MS	48	4927076		4927076	51.95		51.95	7.54
Bernalillo	Bernalillo MS	49	1992800		1992800	18.78		18.78	3.20
Cobre	Snell MS	50	5463200		5463200	58.83		58.83	7.64
Los Lunas	Los Lunas MS	51	2764500		2764500	26.60		26.60	4.45
Portales	Portales Jr HS	52	5118000		5118000	53.11		53.11	5.87
Santa Rosa	Santa Rosa MS	53			228000	0.00		4.59	
Socorro	Raymond Sarracino MS	54	17926		17926	0.20		0.20	0.01
TorC	Truth or Consequences MS	55	18194		18194	0.27		0.27	0.02

18. Appendix G: Data Logger Data

Table 18.1: HOBO Datalogger Measurements – Temperature and RH

HOBO Datalogger Measurements (Occupied Hours Summary)																	
Data Logger Summary			Interior Space Temperature °F							Relative Humidity %				Temperature Extremes		Room Perimeter Type	Notes
Count	Serial Number	Room Location	Average	Standard Deviation	Maximum	Minimum	% Time over 74	% Time Below 68	Total >74 and <68	Average	Standard Deviation	Maximum	Minimum	Date of Maximum Temperature	Date of Minimum Temperature		
1	10173670	105-Principal's Office	72.24	2.61	88.47	65.34	23.04%	1.55%	24.58%	26.45	7.29	50.58	15	11/21/2013 15:25	11/7/2013 5:55	Southwest	
2	10173671	112-Staff Dinning	73.34	1.56	80.56	70.31	39.76%	0.00%	39.76%	25.80	6.75	43.79	15	11/21/2013 15:30	11/28/2013 9:00	Southwest	Data on 10 minute interval
3	10173673	126-Nurse's Office	71.56	2.37	82.15	62.08	3.45%	8.99%	12.44%	28.25	6.82	48.07	15	11/21/2013 15:30	11/7/2013 8:10	East	
4	10173643	201-Classroom	72.38	1.31	80.74	67.56	5.24%	1.37%	6.61%	26.83	6.69	44.74	15	11/21/2013 15:30	11/28/2013 8:20	Northeast	
5	10173669	213-Library	72.53	1.77	88.47	68.93	15.30%	0.00%	15.30%	26.08	6.42	42.37	15	11/21/2013 15:25	11/28/2013 8:35	Southwest	
6	10173658	217-Server Room	71.32	1.38	85.19	69.45	1.25%	0.00%	1.25%	27.73	6.58	44.64	15	11/21/2013 15:30	11/28/2013 8:40	West	
7	10173659	227-Classroom	70.66	1.58	80.56	66.02	0.83%	5.30%	6.13%	30.77	6.14	49.45	15	11/21/2013 15:30	11/28/2013 9:20	North	
8	10067898	308-S Degler	71.58	1.11	80.21	67.56	0.77%	4.23%	5.00%	30.55	5.22	43.78	15	11/21/2013 15:30	11/28/2013 8:00	North	
9	10067911	310-L Araiza	72.19	1.68	88.28	67.39	4.88%	4.05%	8.93%	28.52	5.51	42.96	15	11/21/2013 15:25	11/28/2013 8:15	Northeast	
10	10173644	311-Reading Classroom	72.92	1.50	88.83	68.59	13.45%	0.00%	13.45%	28.45	5.30	43.17	15	11/21/2013 15:25	11/28/2013 8:40	East	
11	10173645	314-Student Showcase	72.46	0.98	79.33	70.65	9.82%	0.00%	9.82%	26.38	6.32	39.61	15	11/21/2013 15:35	11/28/2013 9:25	South	
12	10173654	317-Team Prep	73.34	0.98	80.03	70.14	18.81%	0.00%	18.81%	25.92	5.86	38.97	15	11/21/2013 15:30	11/28/2013 8:30	South	
13	10173668	329-Tech Room	73.78	1.26	88.10	68.42	32.08%	0.00%	32.08%	27.55	5.15	41.08	15	11/21/2013 15:25	11/28/2013 8:55	Interior	

HOBO Datalogger Measurements (Occupied Hours Summary)

Data Logger Summary			Interior Space Temperature °F							Relative Humidity %				Temperature Extremes		Room Perimeter Type	Notes
Count	Serial Number	Room Location	Average	Standard Deviation	Maximum	Minimum	% Time over 74	% Time Below 68	Total >74 and <68	Average	Standard Deviation	Maximum	Minimum	Date of Maximum Temperature	Date of Minimum Temperature		
14	10067912	402-A Garcia	71.85	3.72	78.80	48.16	12.20%	7.32%	19.52%	30.84	4.68	50.43	18.7	11/21/2013 15:30	11/21/2013 9:15	North	
15	10173662	404-Science Lab Grijalva	72.40	3.75	81.62	48.70	29.11%	2.80%	31.90%	30.48	4.56	51.26	18.75	11/21/2013 15:30	11/21/2013 9:10	North	
16	10173663	409-Classroom M Torrez	71.66	3.33	78.45	48.52	5.89%	7.08%	12.98%	29.95	5.62	52.06	15	11/21/2013 15:30	11/21/2013 9:05	North	
17	10173672	413-Engineering Lab	72.40	3.30	83.94	47.45	10.12%	2.56%	12.68%	26.15	6.30	47.91	15	11/21/2013 15:30	11/21/2013 9:10	South	
18	10173660	429-Tech Room	73.68	3.58	80.91	47.09	58.87%	2.86%	61.73%	26.09	6.09	48.88	15	11/21/2013 15:30	11/21/2013 9:00	Interior	
19	10173666	501-Classroom A Martos	71.80	3.96	82.15	47.45	13.63%	8.99%	22.62%	29.15	5.80	54.56	15	11/21/2013 15:30	11/21/2013 9:00	Northeast	
20	10173664	503-Special Ed J Coca	70.51	3.28	81.27	47.98	0.83%	7.32%	8.15%	28.65	5.98	50.37	15	11/21/2013 15:30	11/21/2013 9:05	North	
21	2417102	510-A Martinez	71.64	3.38	80.56	48.52	7.08%	2.86%	9.94%	26.87	5.32	54.76	15	11/21/2013 15:30	11/21/2013 9:10	Northwest	
22	10067917	512-Office	70.83	3.23	80.74	46.37	2.74%	4.17%	6.90%	28.52	5.76	52.52	15	11/21/2013 15:30	11/21/2013 9:00	Southwest	
23	10173652	517-Team Prep	72.72	3.48	79.15	48.52	24.17%	2.86%	27.02%	27.88	5.70	53.8	15	11/20/2013 16:35	11/21/2013 9:15	South	
24	10173667	521-S Rodriguez VP	72.61	3.62	80.56	48.16	20.89%	2.74%	23.63%	26.05	6.57	49.03	15	11/10/2013 16:55	11/21/2013 9:15	South	
25	10173651	522-Classroom V Madrid	72.00	3.49	77.92	47.62	15.18%	2.86%	18.04%	30.02	5.34	50.45	15	11/20/2013 16:35	11/21/2013 8:55	Southeast	
26	10173661	528-Learning Lab	71.94	3.24	88.83	47.27	2.44%	2.32%	4.76%	27.65	5.54	48.13	15	11/21/2013 15:25	11/21/2013 8:55	Interior	
27	10173665	632-Band	70.92	3.29	77.92	47.27	2.14%	2.74%	4.88%	27.15	6.84	51.37	15	11/20/2013 16:30	11/21/2013 9:00	West	Data on 10 minute

GENUINE | PROGRESSIVE | ADVOCATES



HOBO Datalogger Measurements (Occupied Hours Summary)																	
Data Logger Summary			Interior Space Temperature °F							Relative Humidity %				Temperature Extremes		Room Perimeter Type	Notes
Count	Serial Number	Room Location	Average	Standard Deviation	Maximum	Minimum	% Time over 74	% Time Below 68	Total >74 and <68	Average	Standard Deviation	Maximum	Minimum	Date of Maximum Temperature	Date of Minimum Temperature		
																	interval
28	10173656	Cafeteria	72.05	3.43	80.74	48.34	21.96%	4.35%	26.31%	26.42	7.06	54.18	15	11/21/2013 15:30	11/21/2013 8:55	Southwest	
29	10067901	Gym	71.04	3.26	80.38	48.52	4.52%	2.74%	7.26%	27.33	7.31	53.25	15	11/21/2013 15:30	11/21/2013 9:20	North	
30	10173657	Kitchen	77.91	4.89	84.30	49.05	89.05%	2.86%	91.90%	24.63	6.83	48.59	15	10/31/2013 10:00	11/21/2013 9:15	Northwest	

Table 18.2: FMS Trending Measurements – Temperature

FMS Measurements (Occupied Hours Summary)									
Data Logger Summary			Interior Space Temperature °F						
Count	Serial Number	Room Location	Average	Standard Deviation	Maximum	Minimum	% Time over 74	% Time Below 68	Total >74 and <68
1		100	69.36	1.31	72.79	65.41	0.00%	14.90%	14.90%
2		105-Principal's Office	71.47	2.07	78.96	67.68	9.82%	0.42%	10.23%
3		112-Staff Dinning	71.70	1.41	75.06	65.86	8.07%	1.09%	9.15%
4		126-Nurse's Office	71.41	1.10	75.10	65.86	2.46%	1.70%	4.16%
5		201-Classroom	71.15	0.90	73.44	64.36	0.00%	19.25%	19.25%
6		213 Library HP 2-5	69.73	0.63	71.62	68.34	0.00%	0.00%	0.00%
7		213 Library HP 2-6	69.89	0.60	71.51	68.46	0.00%	0.00%	0.00%
8		213 Library HP 2-10	70.28	0.60	71.80	68.56	0.00%	0.00%	0.00%

FMS Measurements (Occupied Hours Summary)									
Data Logger Summary			Interior Space Temperature °F						
Count	Serial Number	Room Location	Average	Standard Deviation	Maximum	Minimum	% Time over 74	% Time Below 68	Total >74 and <68
9		217-Server classroom	70.80	0.44	71.92	70.08	0.00%	0.00%	0.00%
10		227-Classroom	70.59	1.00	72.22	66.37	0.00%	2.86%	2.86%
11		308-S Degler Classroom	70.41	0.64	71.86	67.04	0.00%	1.76%	1.76%
12		310-L Araiza Classroom	70.91	1.03	73.96	67.24	0.00%	1.81%	1.81%
13		311-Reading Classroom	70.28	0.66	72.93	68.55	0.00%	0.00%	0.00%
14		314-Student Showcase	70.26	0.43	71.33	68.92	0.00%	0.00%	0.00%
15		317-Team Prep	70.92	0.74	73.09	68.50	0.00%	0.00%	0.00%
16		329-Tech Classroom	70.77	0.97	74.81	69.80	0.82%	0.00%	0.82%
17		402-A Garcia Classroom	71.04	1.12	72.62	66.12	0.00%	1.37%	1.37%
18		404-Science Lab Grijalva	71.07	1.19	73.64	62.44	0.00%	1.83%	1.83%
19		409-Classroom M Torrez	70.65	0.97	71.88	66.22	0.00%	1.54%	1.54%
20		413-Engineering Lab	70.62	0.51	72.16	69.61	0.00%	0.00%	0.00%
21		429-Tech Room	71.01	0.87	74.06	70.03	0.11%	0.00%	0.11%
22		501-Classroom A Martos	70.43	0.77	71.78	66.93	0.00%	1.43%	1.43%
23		503-Special Ed J Coca	70.21	0.75	71.27	66.26	0.00%	1.91%	1.91%
24		510-A Martinez							
25		512-Office	70.34	1.13	73.23	65.96	0.00%	2.04%	2.04%
26		517-Team Prep							
27		521-S Rodriguez VP	70.96	0.76	73.46	68.83	0.00%	0.00%	0.00%
28		522-Classroom V Madrid							
29		528-Learning Lab							
		529	70.64	0.57	72.66	69.90	0.00%	0.00%	0.00%
30		632-Band	70.34	0.55	72.26	68.74	0.00%	0.00%	0.00%

GENUINE | PROGRESSIVE | ADVOCATES



FMS Measurements (Occupied Hours Summary)									
Data Logger Summary			Interior Space Temperature °F						
Count	Serial Number	Room Location	Average	Standard Deviation	Maximum	Minimum	% Time over 74	% Time Below 68	Total >74 and <68
31		Cafeteria	70.06	1.10	74.31	66.30	0.41%	0.10%	0.51%
32		Gym	66.32	2.28	73.17	60.99	0.00%	71.92%	71.92%
33		Kitchen 6-22	72.45	1.99	77.45	62.04	20.62%	3.98%	24.60%
34		Kitchen 6-23	73.95	2.85	81.59	62.39	51.15%	3.54%	54.69%

105-PRINCIPAL Hours of Lights 'ON' When Space is Unoccupied

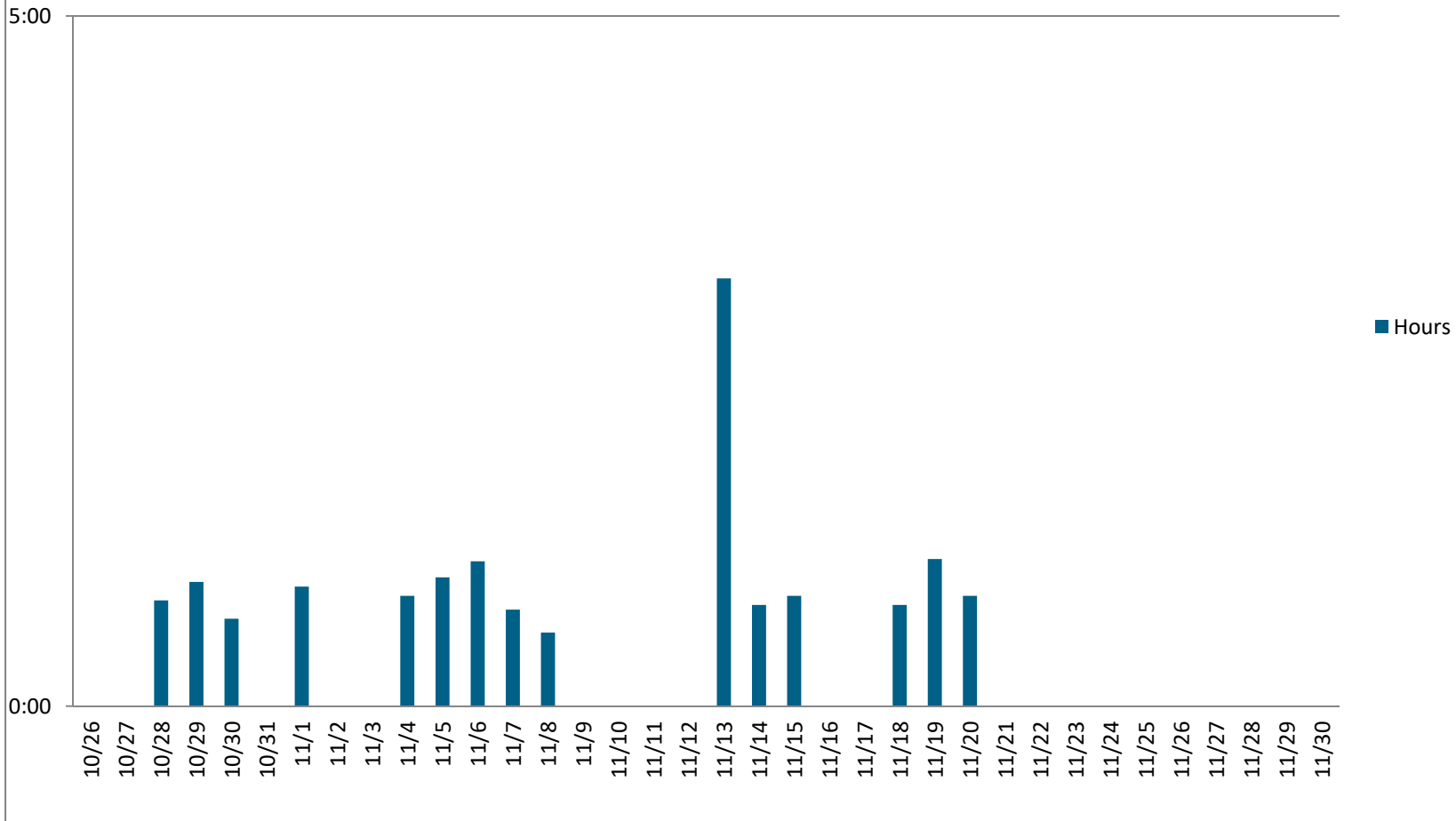

112 - STAFF DINING Hours of Lights 'ON' When Space is Unoccupied

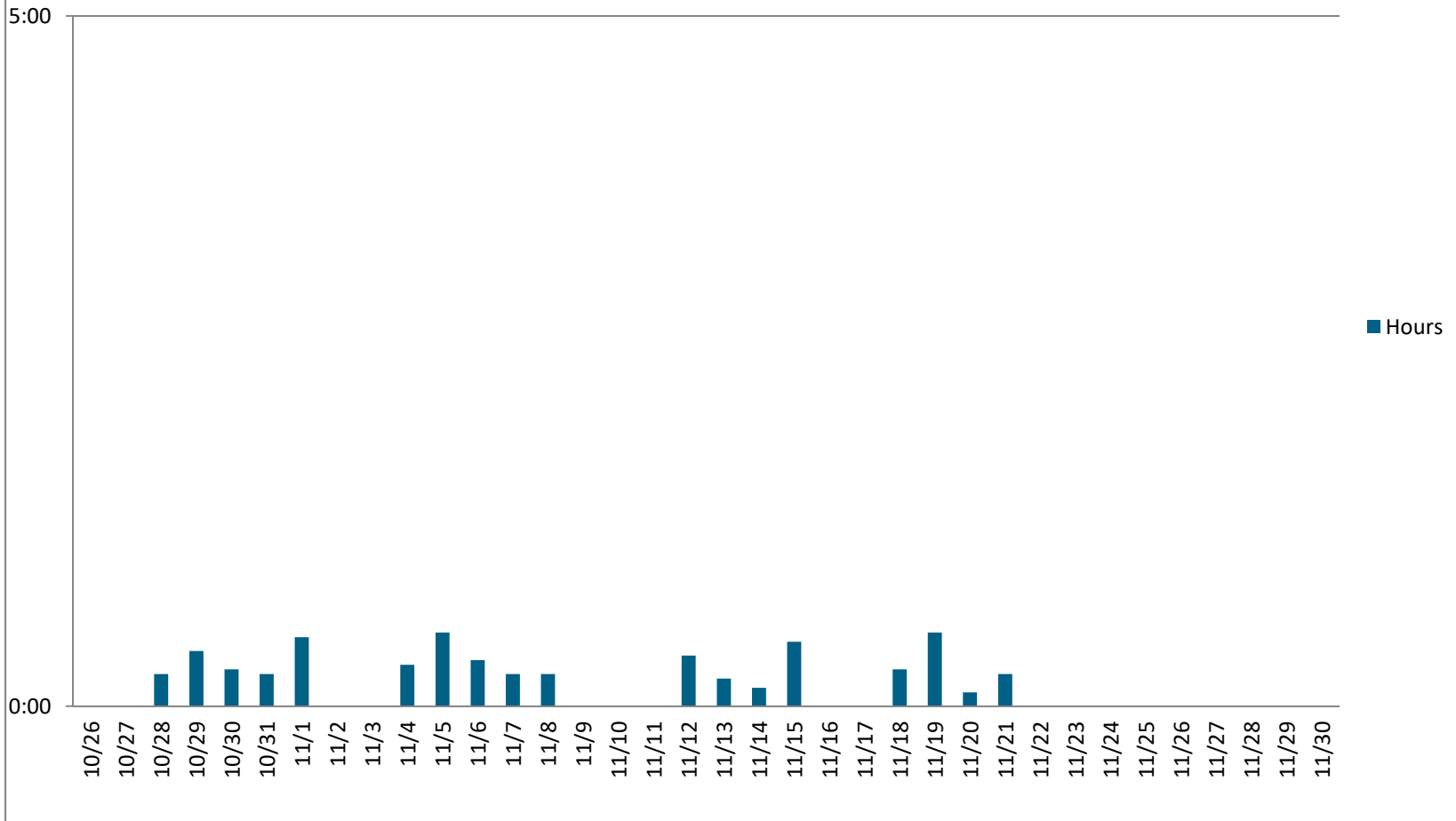

126 - NURSE OFFICE Hours of Lights 'ON' When Space is Unoccupied

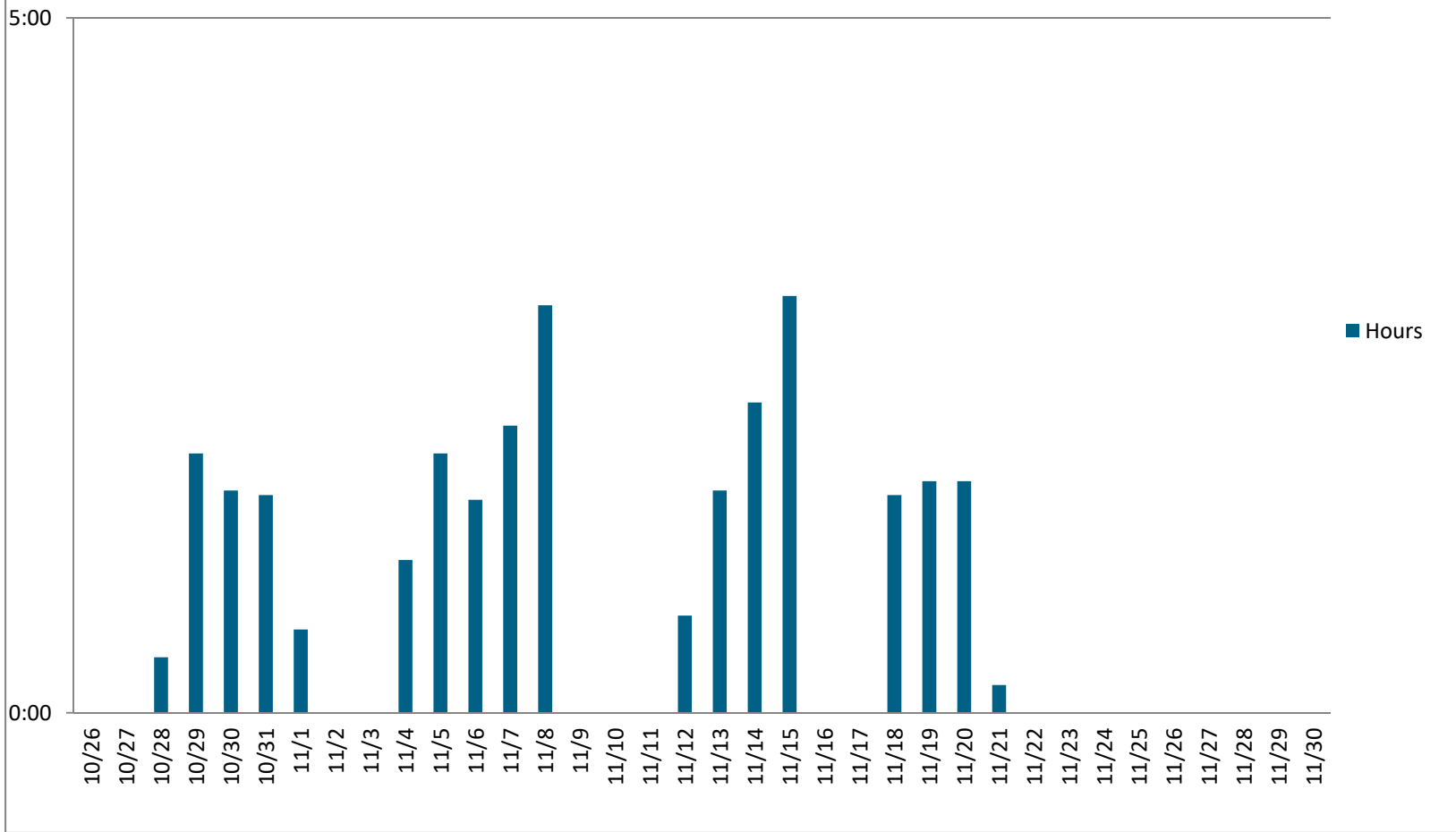

213 - LIBRARY Hours of Lights 'ON' When Space is Unoccupied

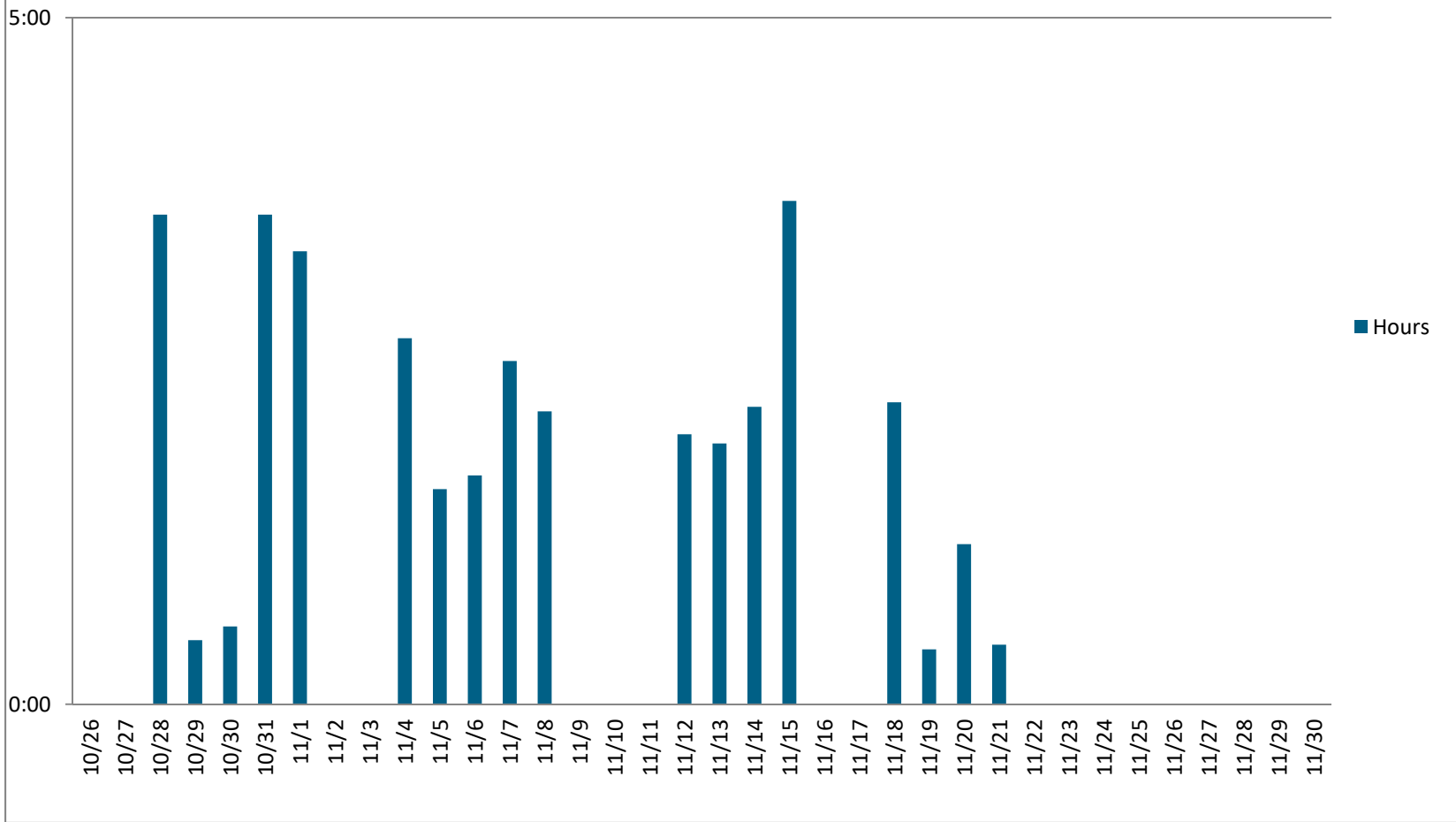

310 - CLASSROOM Hours of Lights 'ON' When Space is Unoccupied

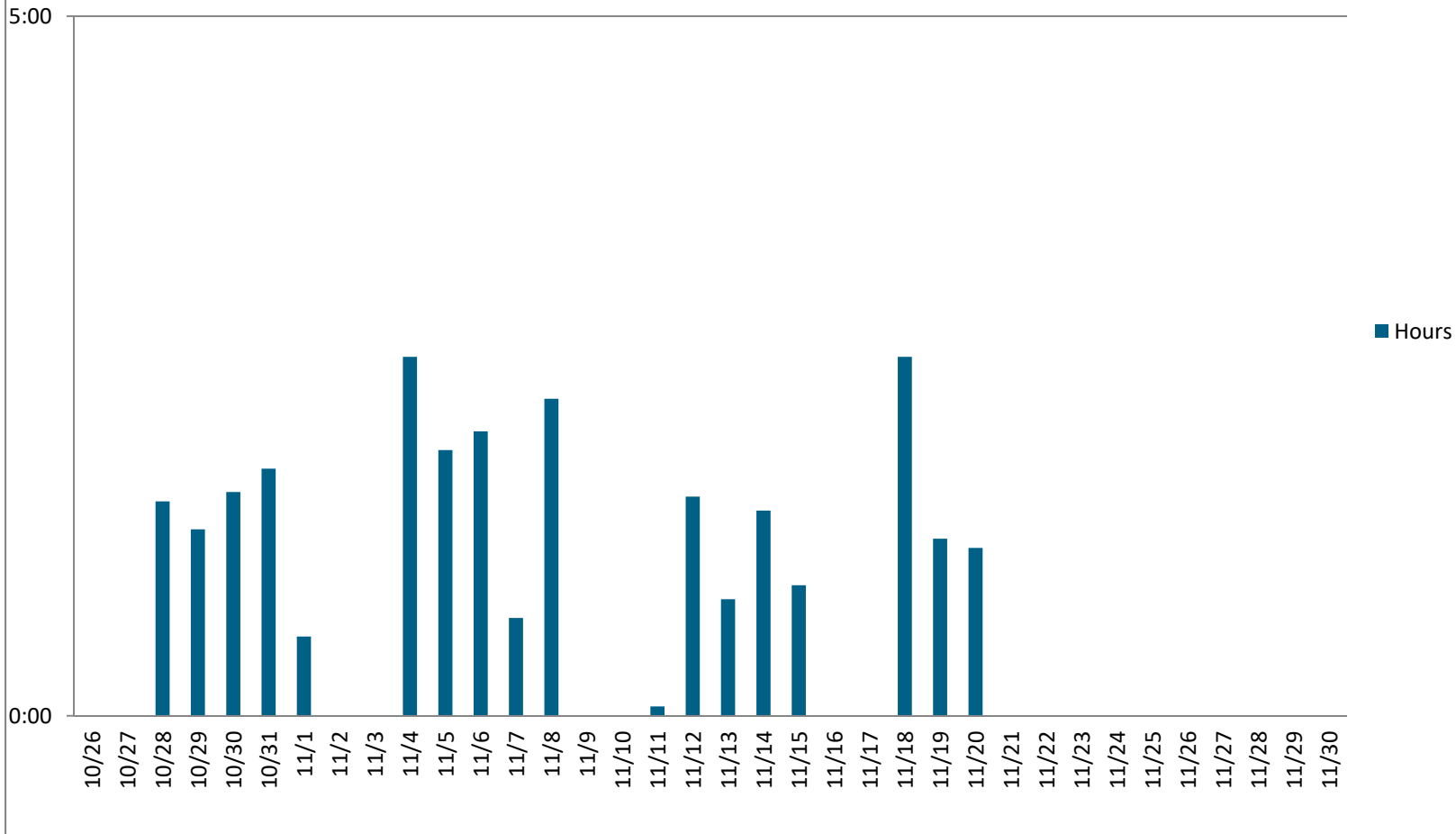

314 - SCIENCE LAB Hours of Lights 'ON' When Space is Unoccupied

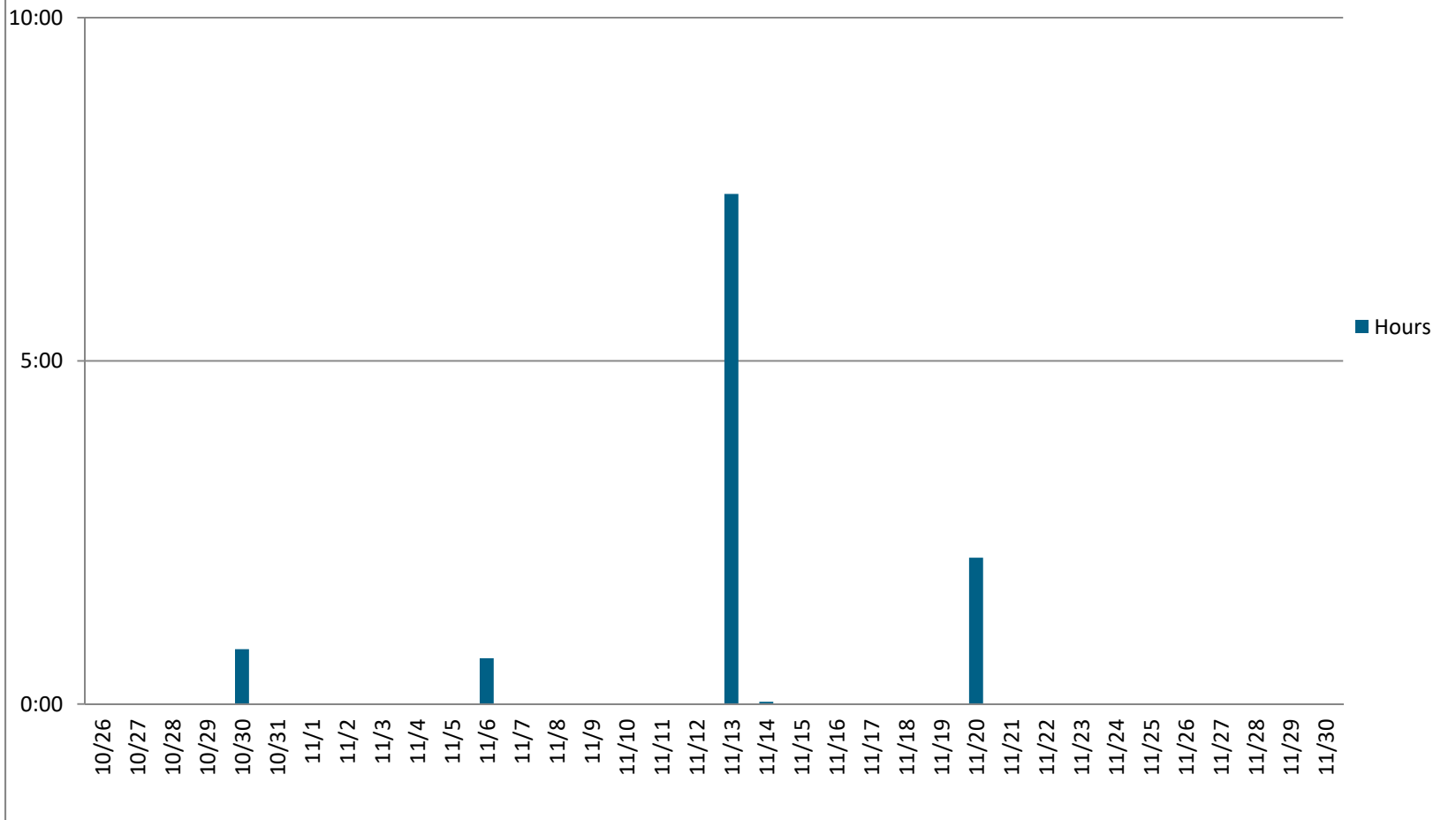

317 - TEAM PREP Hours of Lights 'ON' When Space is Unoccupied

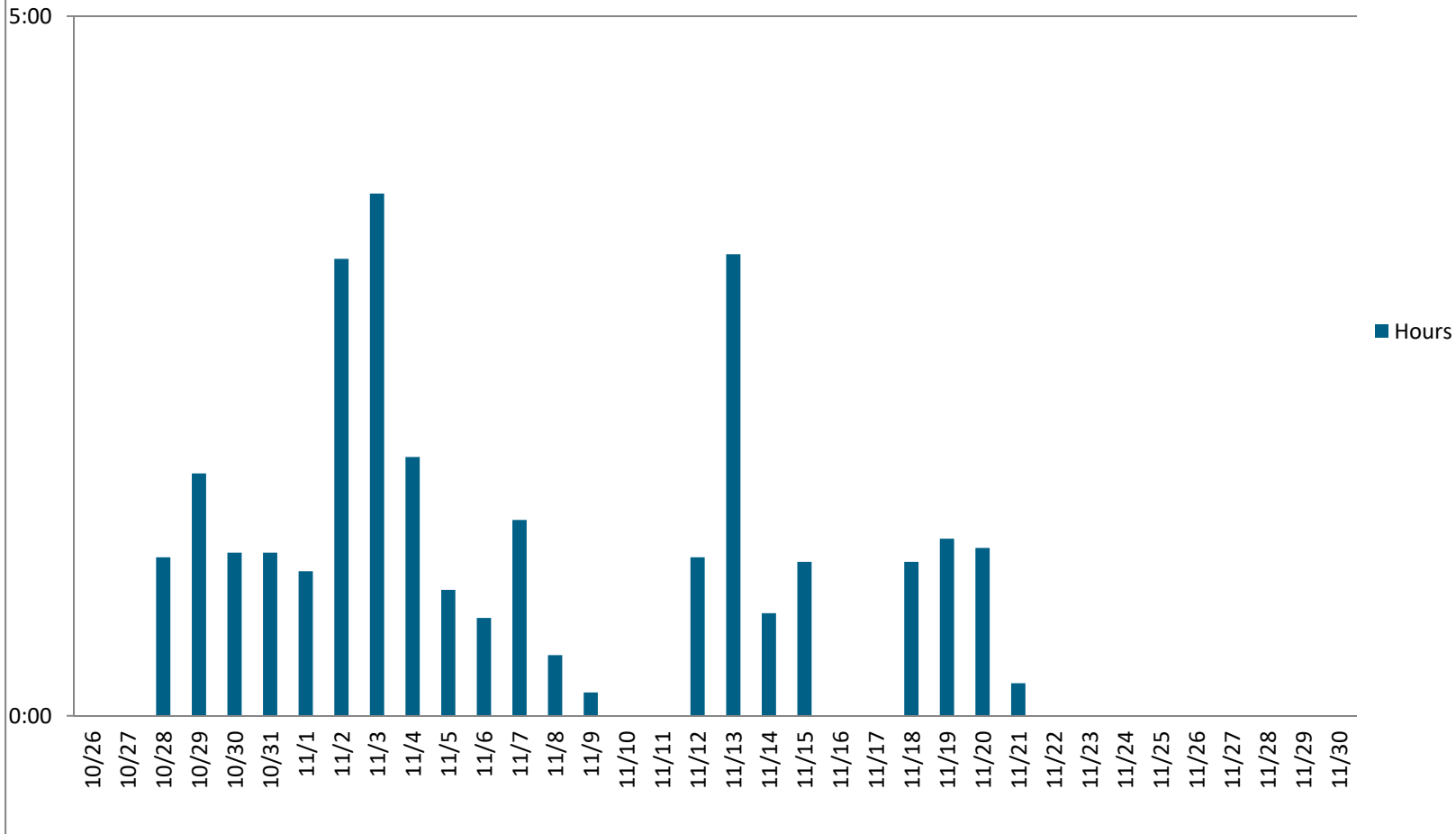

329 - TECH ROOM Hours of Lights 'ON' When Space is Unoccupied

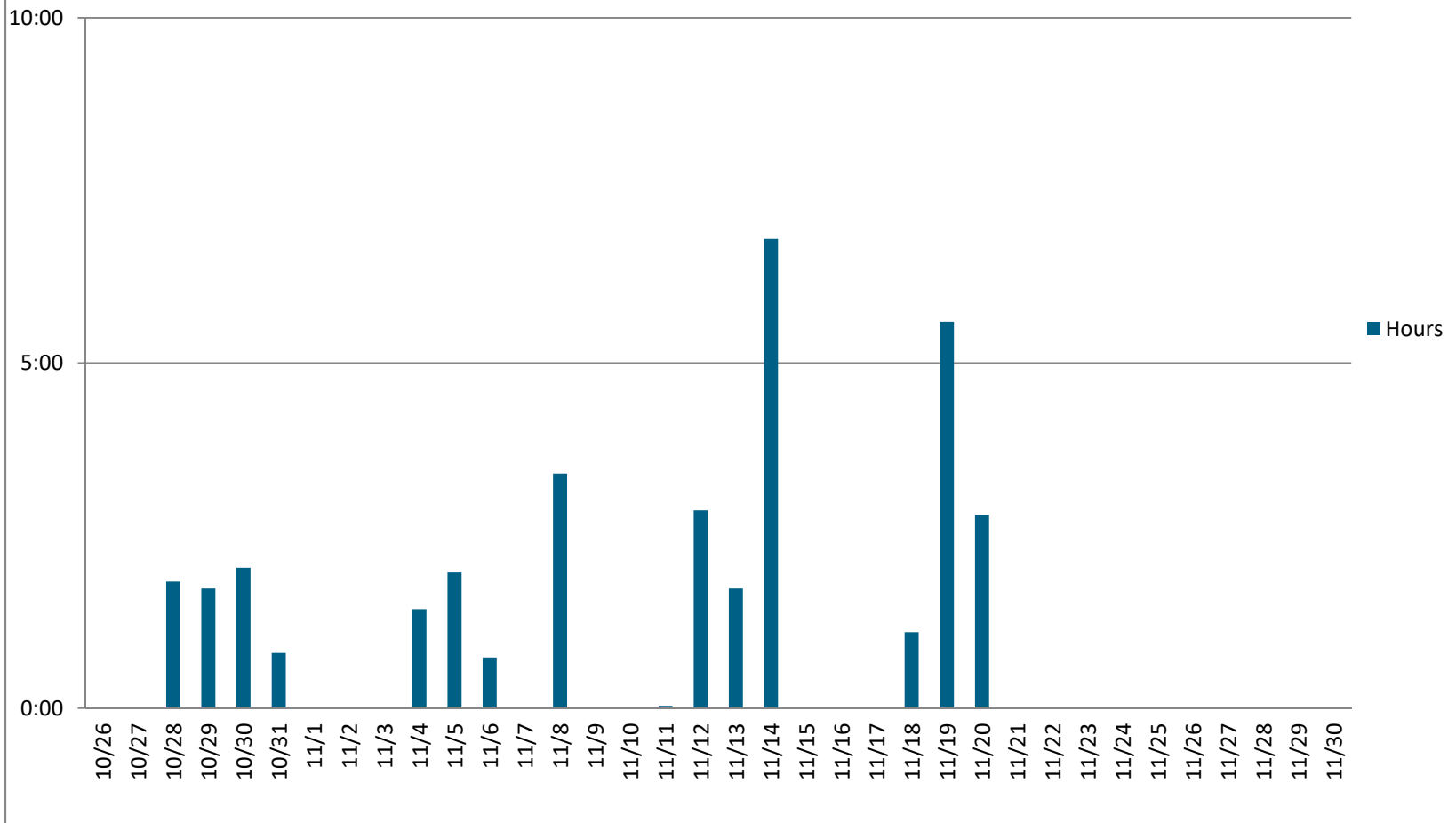

404 - SCIENCE LAB Hours of Lights 'ON' When Space is Unoccupied

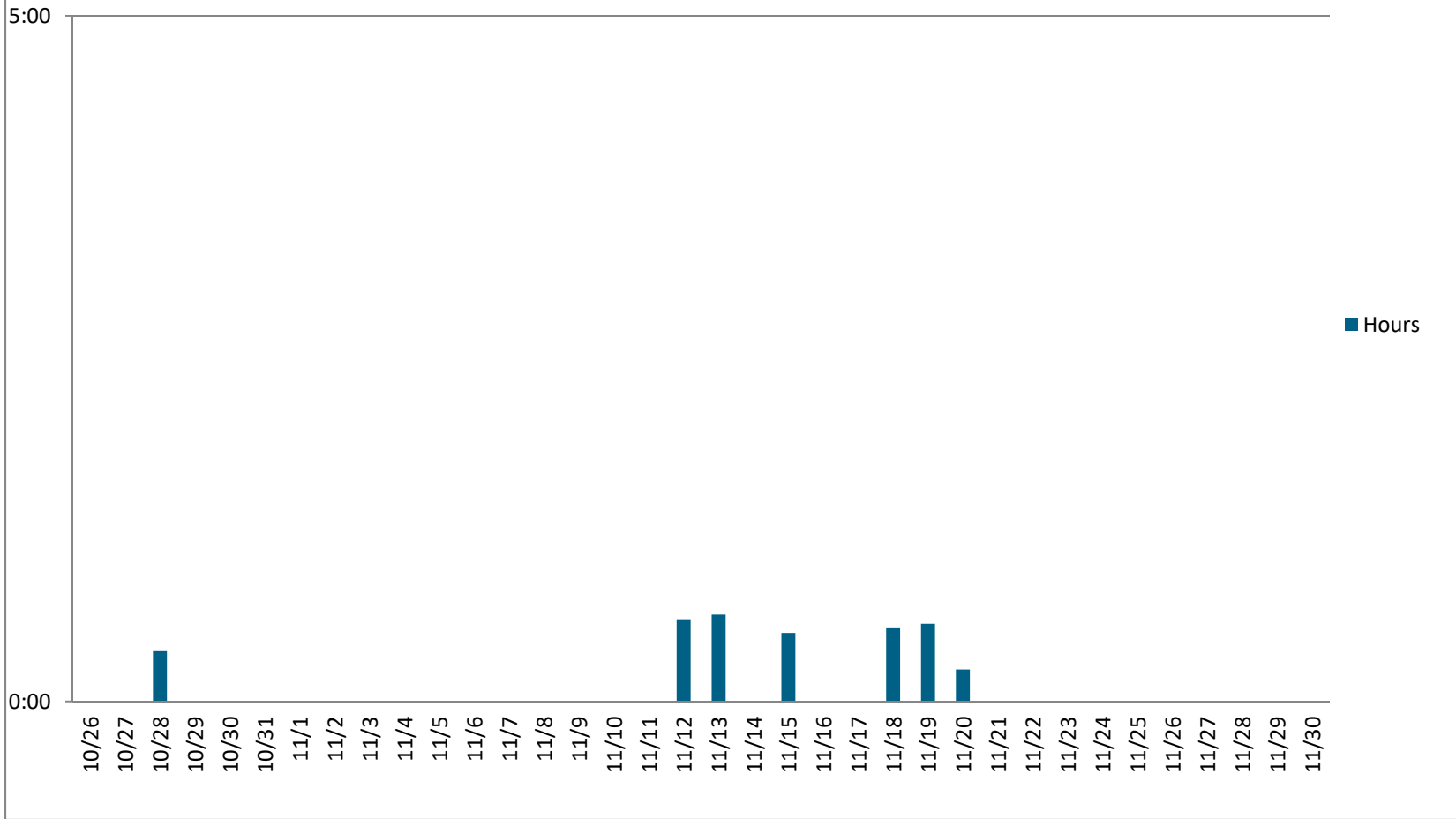

GENUINE | PROGRESSIVE | ADVOCATES



409 - CLASSROOM Hours of Lights 'ON' When Space is Unoccupied

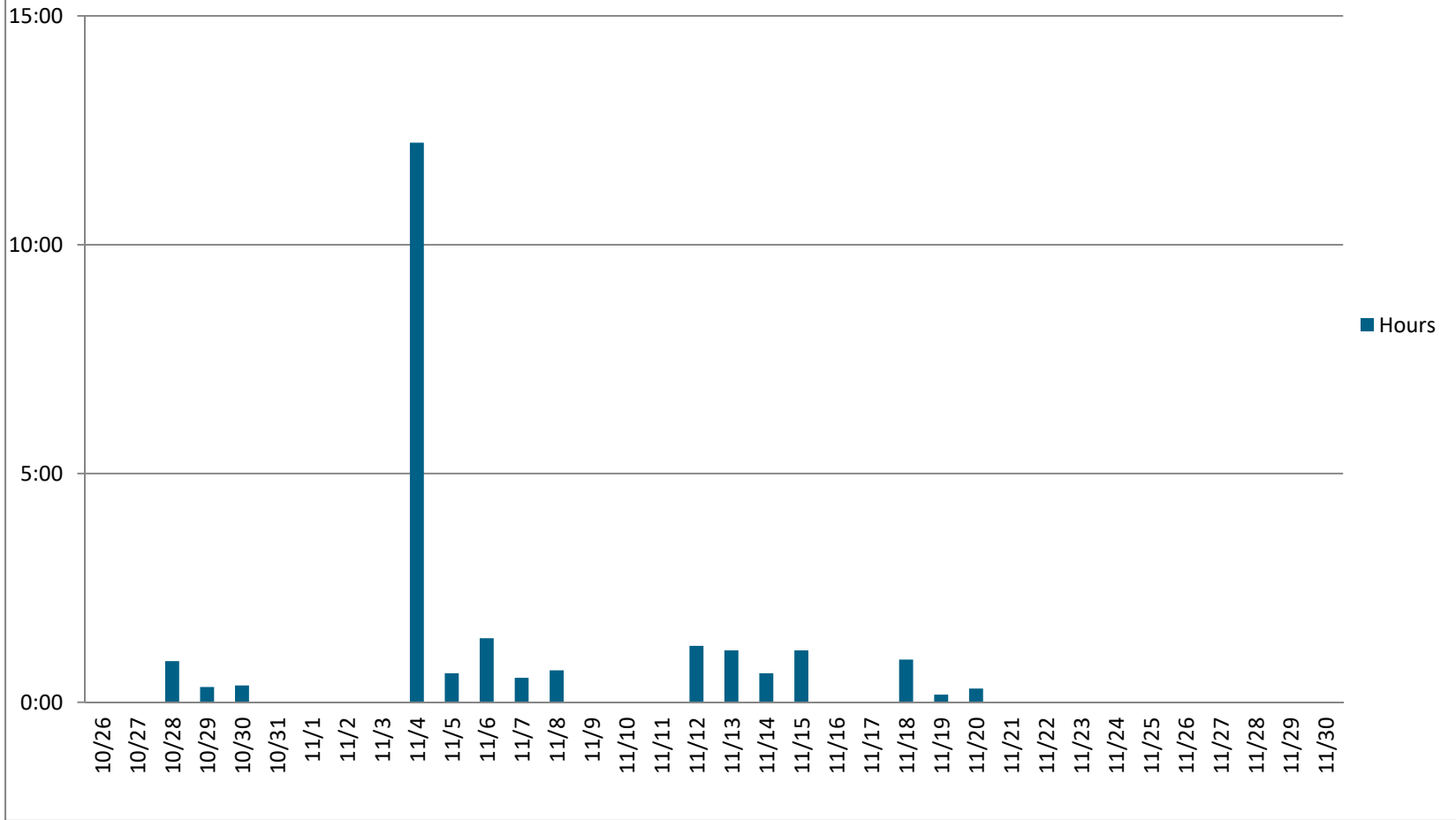

413 - ENGINEERING LAB Hours of Lights 'ON' When Space is Unoccupied

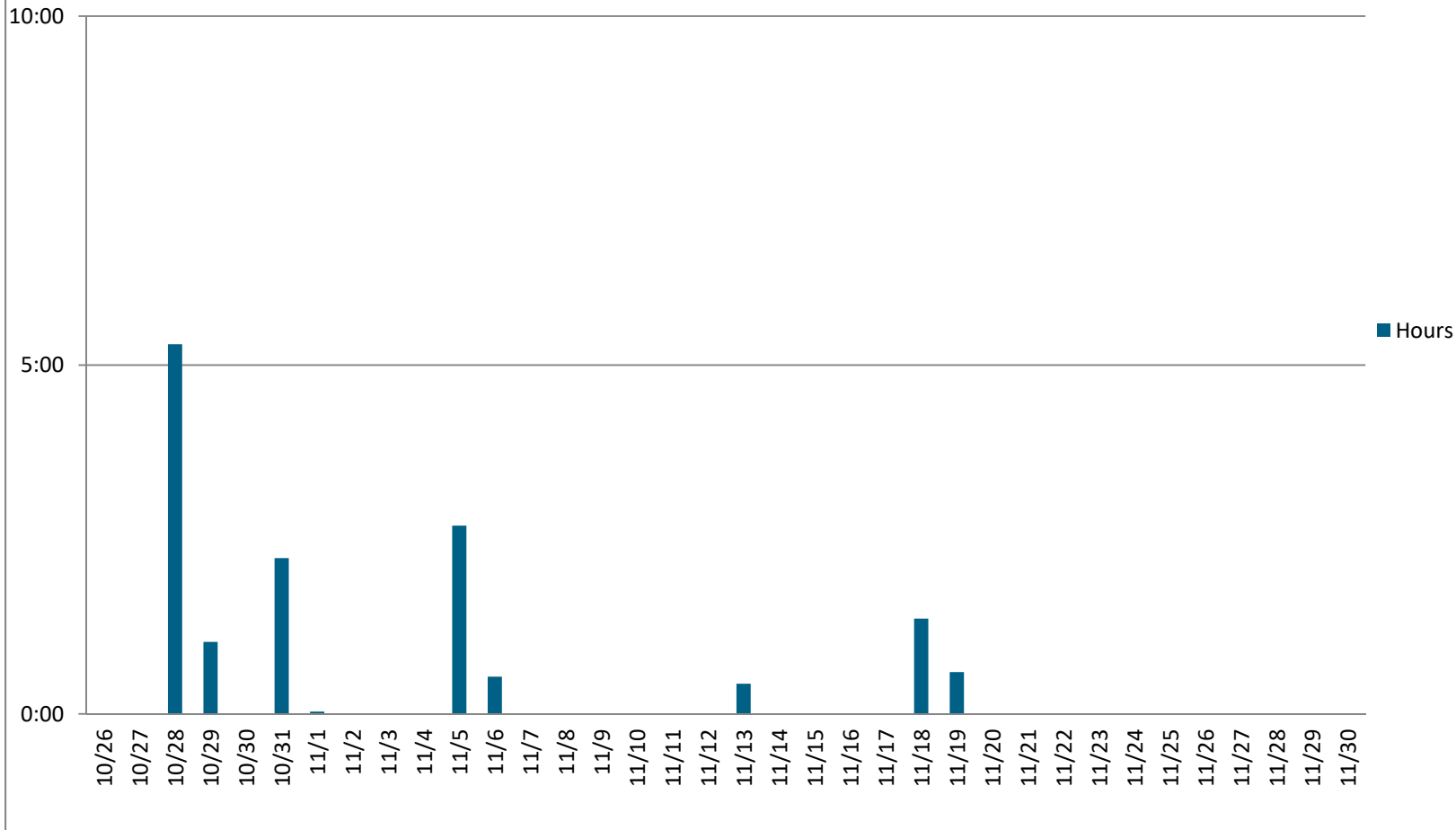

501 - CLASSROOM Hours of Lights 'ON' When Space is Unoccupied

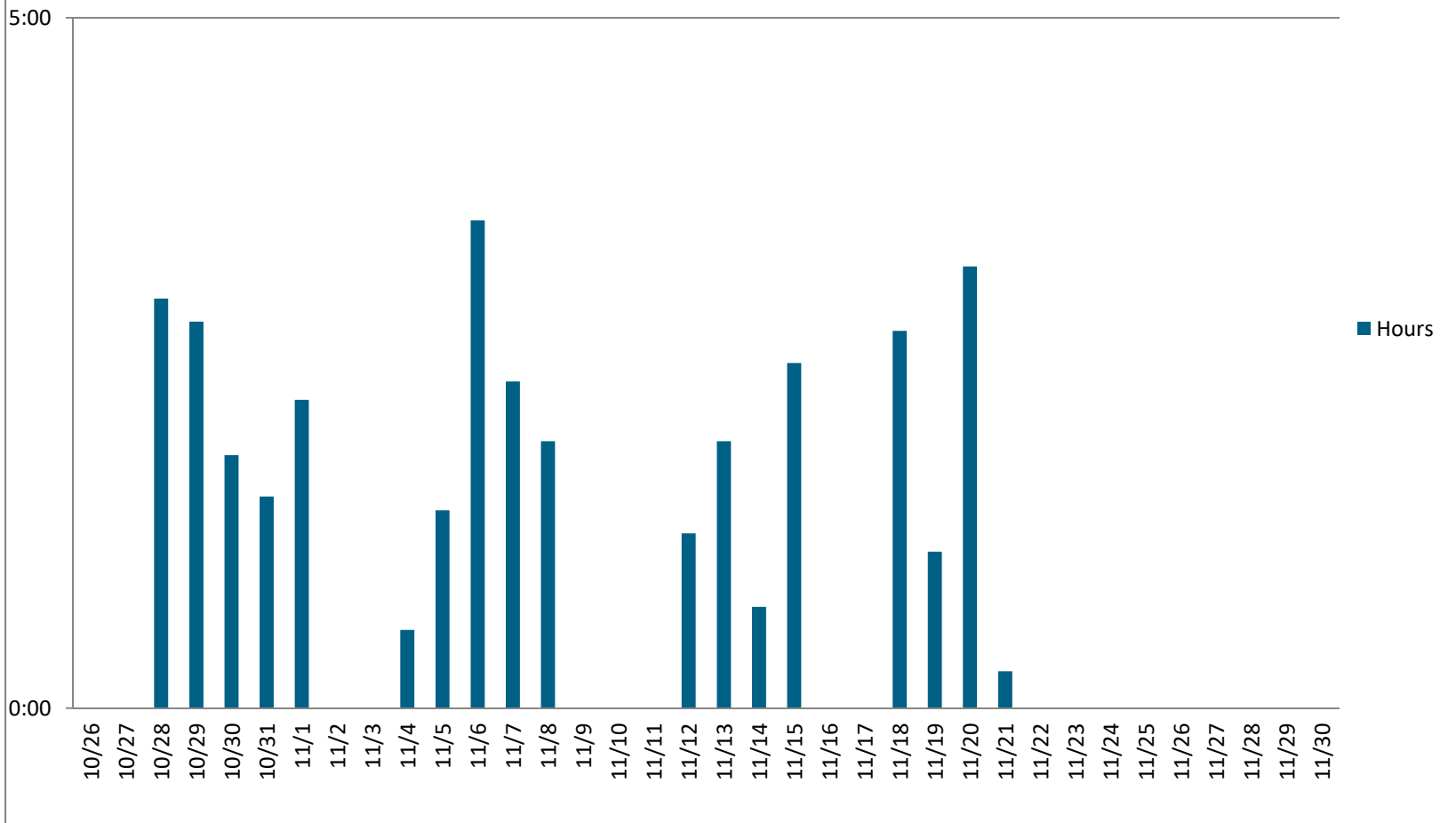

Team Prep - Room 517 Hours of Lights 'ON' When Space is Unoccupied

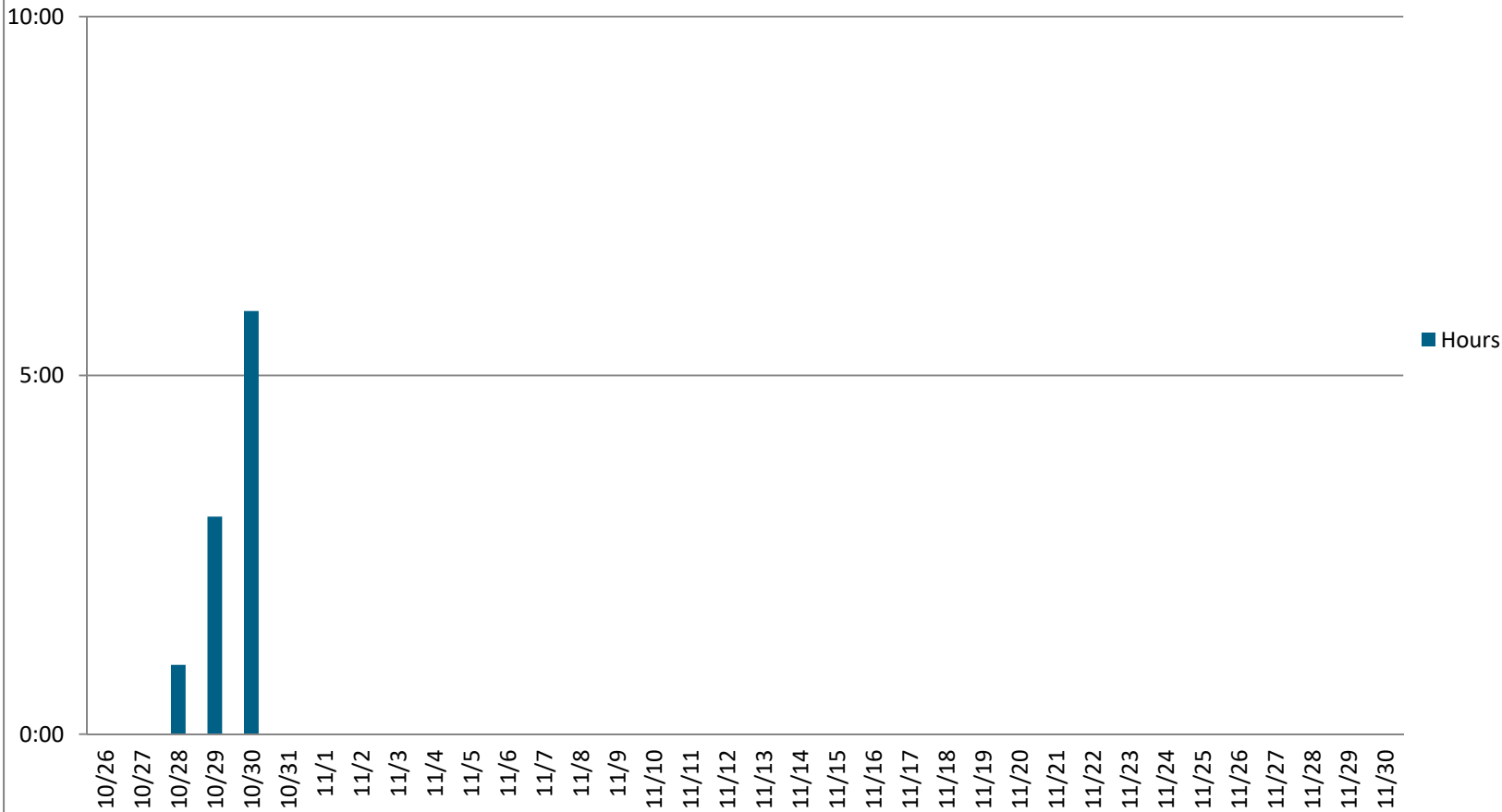

GENUINE | PROGRESSIVE | ADVOCATES



528 - LEARNING LAB Hours of Lights 'ON' When Space is Unoccupied

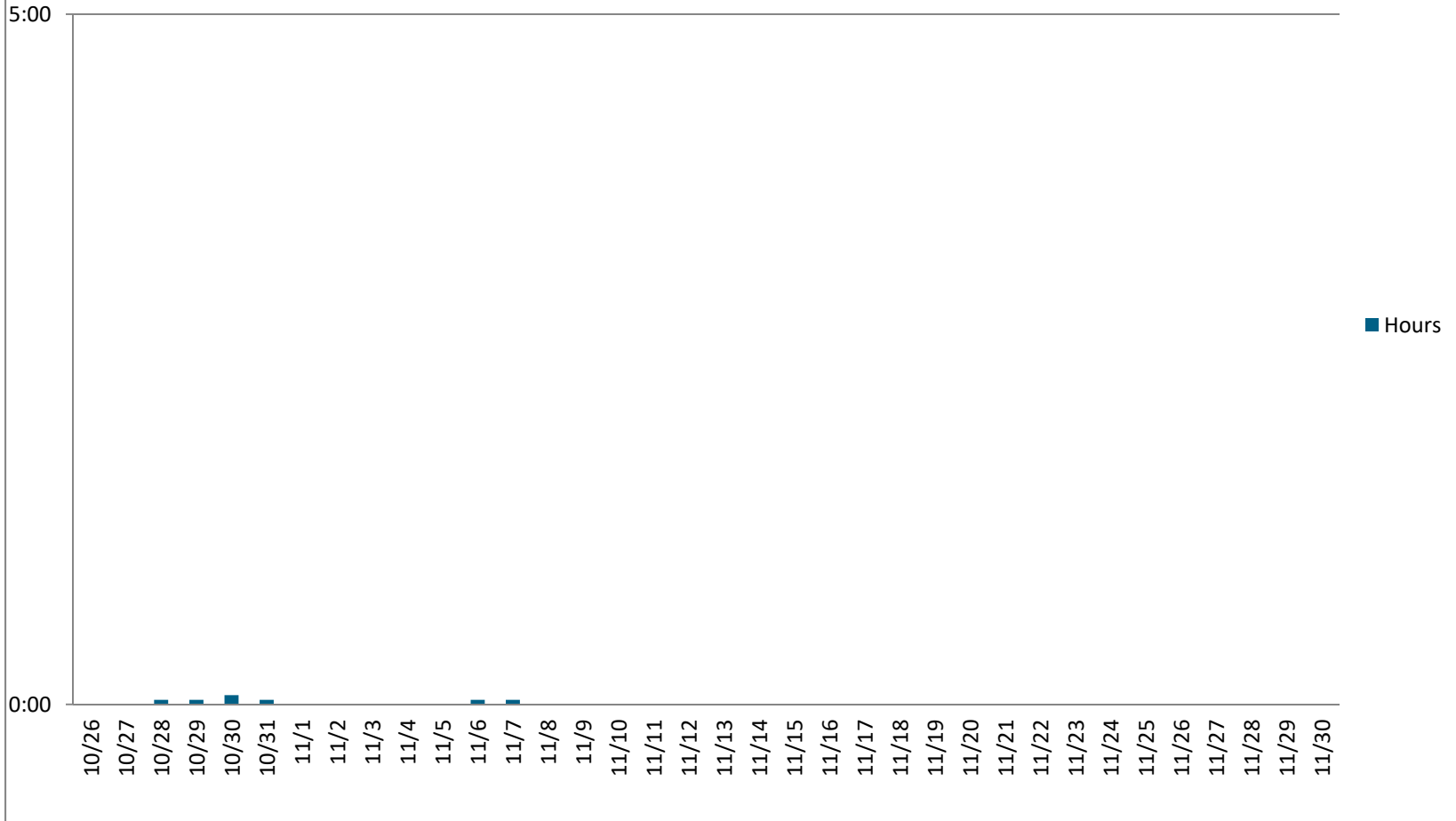

GENUINE | PROGRESSIVE | ADVOCATES



602A - KITCHEN Hours of Lights 'ON' When Space is Unoccupied

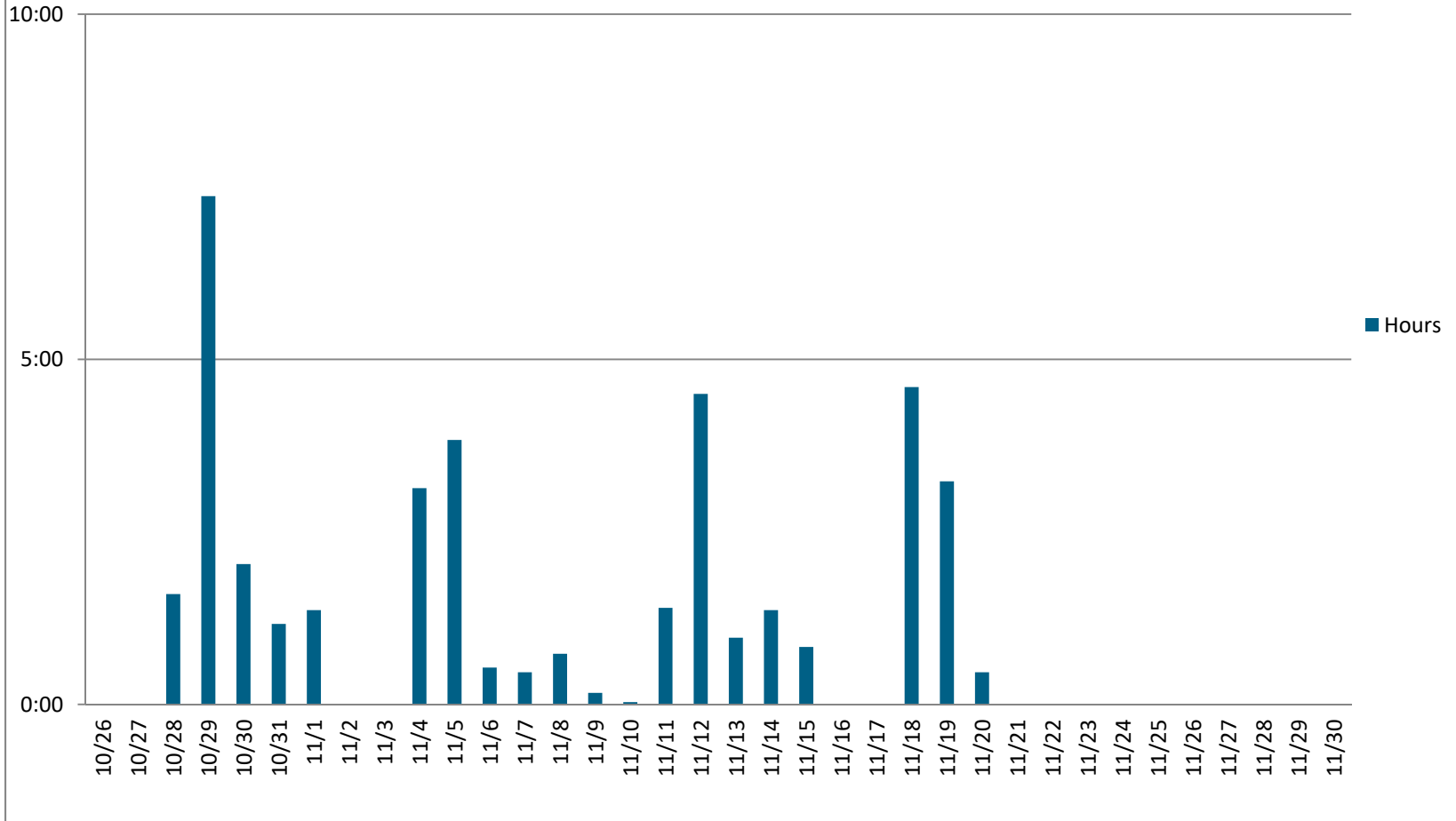

618 CAFETERIA Hours of Lights 'ON' When Space is Unoccupied

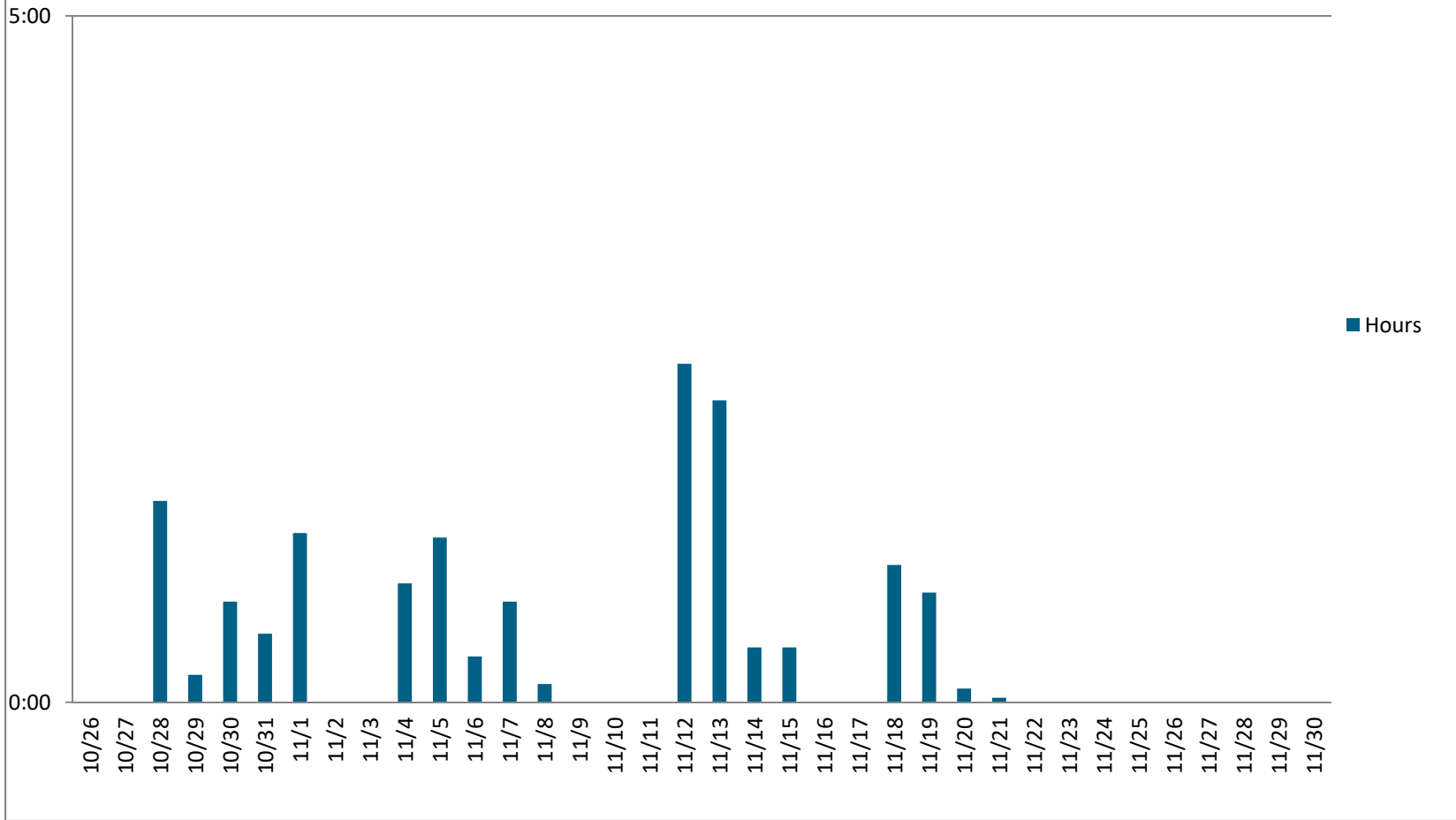

632 - BAND Hours of Lights 'ON' When Space is Unoccupied



GENUINE | PROGRESSIVE | ADVOCATES



Gymnasium - Room 653 Hours of Lights 'ON' When Space is Unoccupied

